

HSF

NOTES:

- 1.Current Rating:2A Max (only one pin) ;
- 2.Voltage Rating:175V DC;
- 3.Contact Resistance:30mΩ Max;
- 4.Withstand Voltage:675V AC;
- 5.Insulation Resistance:5000MΩ Min;
- 6.Operating Temperature: -55°C to +125°C;
- 7.Insulator Material: LCP,G.F,UL94V-0,BK;
- 8.Contact Material:Copper Alloy;
- 9.Contact plating:
Au on contact area (See ordering information),
100μ" Matte TIN on solder area,
50μ" Nickel underplating overall;
- 10.Recommended process:
Wavesolder,Peak temperature:260±5°C, 5s ;

Ordering Information

37 2 0 X- S M XXX XXX XX X XX

OPTIONS

- 1=A
- 2=LC
- 3=FL

S=SOCKET

M=180° SMT

No OF POSITIONS

- 060=60PIN
- 120=120PIN
- 180=180PIN
- 240=240PIN
- 300=300PIN

LEAD STYLE

032=3.25

WCON INTERNAL CODE

PACKAGING
A=VACUUM BOX
R=TAPE&REEL

PLATING

- W1=SEL.3U"GOLD/MATTE SN
- W3=SEL.10U"GOLD/MATTE SN
- W5=SEL.30U"GOLD/MATTE SN

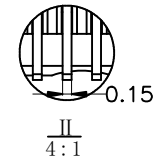
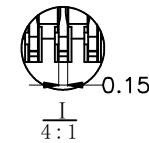
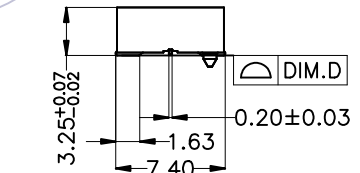
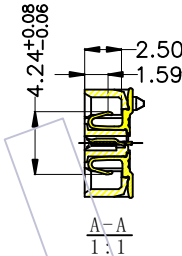
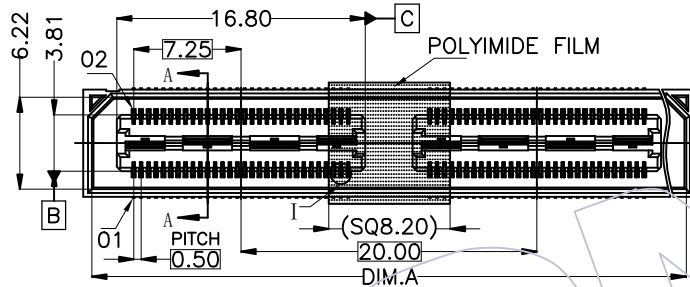

REV	DATE	MODIFICATION DESCRIPTION	CHANGE	OPERATION	DRAW	DATE	SCALE	Fit	PART NO.
				x.x ±0.40	Abt Chen	2022.04.06	UNIT	mm	3720X-SMXXX-032XXX01
				x.xx ±0.25	CHECK	DATE	SIZE	A4	TITLE:
				x.xxx ±0.15	APPROVE	DATE	SHEET	1/4	0.5mmB0 TO B0 SOCKET SMT, H=3.25, ASSEMBLY
				Angle ± 3°			PROJ.	⌀	Customer NO.
				DIM TOL					

WCON

Http: www.wcon.com

WCON-Dongguan
Tel: +86 769 85358920
Fax: +86 769 85358915
E-mail: sales@wcon.com

WCON-Kunshan
Tel: +86 512 57468408
Fax: +86 512 57468468
E-mail: salesks@wcon.com

HSF

SPECIFICATION&SIZE LIST

OPTIONS	P/N	PIN	DIM.A	DIM.B	DIM.C	DIM.D	DIM.E
-A (CONVENTION)	37201-SM060-032XXX01	2*30	20.18	20.13	21.31	0.10	
	37201-SM120-032XXX01	2*60	40.18	40.13	41.31	0.10	
	37201-SM180-032XXX01	2*90	60.18	60.13	61.31	0.15	
	37201-SM240-032XXX01	2*120	80.18	80.13	81.31	0.15	
	37201-SM300-032XXX01	2*150	100.18	100.13	101.31	0.15	
-LC (LOCKING CLIPS)	37202-SM060-032XXX01	2*30	20.18	20.13	21.31	0.10	
	37202-SM120-032XXX01	2*60	40.18	40.13	41.31	0.10	
	37202-SM180-032XXX01	2*90	60.18	60.13	61.31	0.15	
	37202-SM240-032XXX01	2*120	80.18	80.13	81.31	0.15	
	37202-SM300-032XXX01	2*150	100.18	100.13	101.31	0.15	
-FL (FRICTION LOCKS)	37203-SM060-032XXX01	2*30	20.18	20.13	21.31	0.10	20.25
	37203-SM120-032XXX01	2*60	40.18	40.13	41.31	0.10	40.25
	37203-SM180-032XXX01	2*90	60.18	60.13	61.31	0.15	60.25
	37203-SM240-032XXX01	2*120	80.18	80.13	81.31	0.15	80.25
	37203-SM300-032XXX01	2*150	100.18	100.13	101.31	0.15	100.25

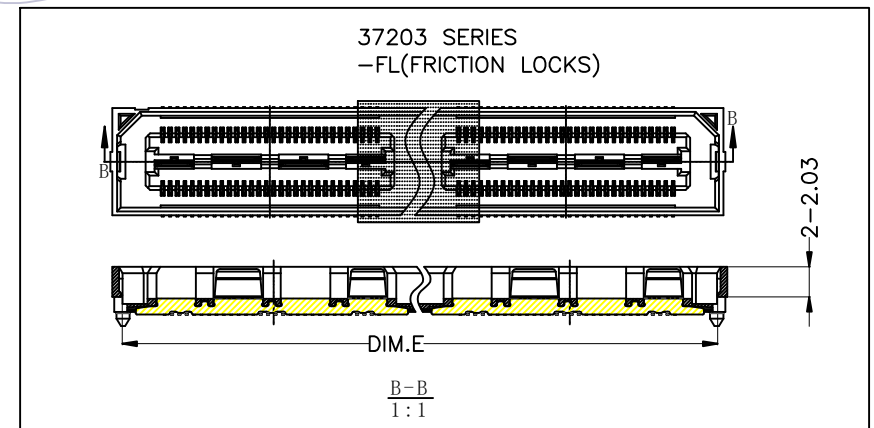
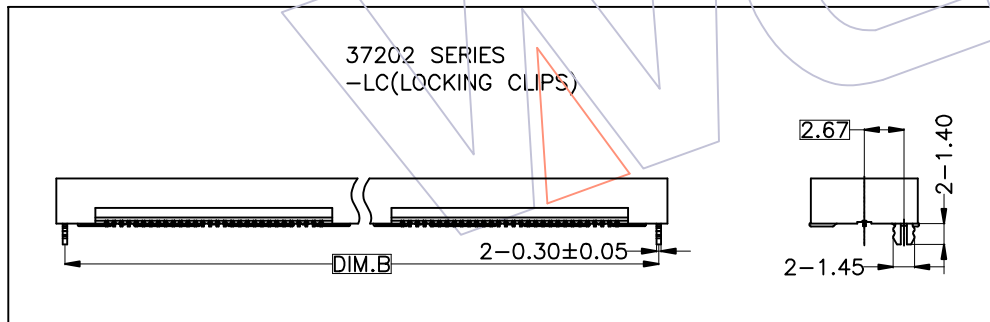

REV	DATE	MODIFICATION DESCRIPTION	CHANGE	OPERATION	DRAW	DATE	SCALE	Fit	PART NO.
A0	2022.04.06	NEW		x.x ±0.40	Abt Chen	2022.04.06	UNIT	mm	3720X-SMXXX-032XXX01
				x.xx ±0.25	CHECK	DATE	SIZE	A4	TITLE:
				x.xxx ±0.15	APPROVE	DATE	SHEET	2/4	0.5mmB0 TO B0 SOCKET SMT, H=3.25, ASSEMBLY
				Angle ± 3°			PROJ.	⊕	Customer NO.
				DIM TOL					

WCON

Http: www.wcon.com

WCON-Dongguan
Tel: +86 769 85358920
Fax: +86 769 85358915
E-mail: sales@wcon.com

WCON-Kunshan
Tel: +86 512 57468408
Fax: +86 512 57468468
E-mail: salesks@wcon.com

HSF

MATED HEIGHT

LENGTH SPECIFICATION DISPLAY

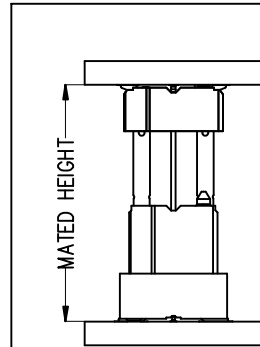
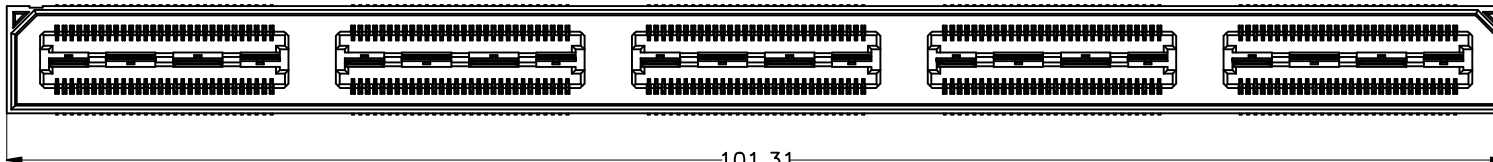
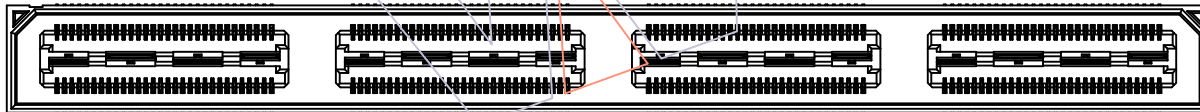
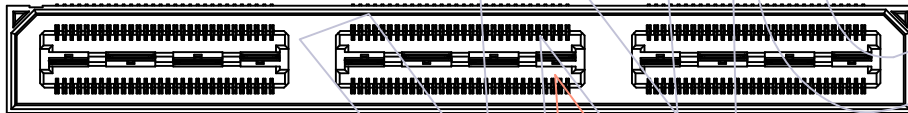
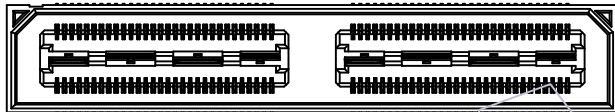
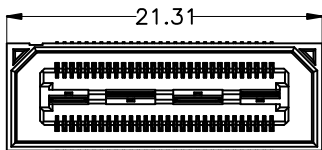

MATED HEIGHT	SOCKET HEIGHT	MALE HEIGHT	DEVELOPMENT STATUS
5.00	3.25	4.26	YES
8.00	3.25	7.26	YES
11.00	3.25	10.26	YES
14.00	3.25	13.26	YES
15.00	3.25	14.26	YES
16.00	3.25	15.24	YES
19.00	3.25	18.24	NEXT
22.00	3.25	21.24	NEXT
25.00	3.25	24.24	NEXT
30.00	3.25	29.24	NEXT

REV	DATE	MODIFICATION DESCRIPTION	CHANGE	OPERATION	DRAW	DATE	SCALE	Fit	PART NO.
A0	2022.04.06	NEW	—	x.x ±0.40	Abt Chen	2022.04.06	UNIT	mm	3720X-SMXXX-032XXX01
				x.xx ±0.25	CHECK	DATE	SIZE	A4	TITLE:
				x.xxx ±0.15	APPROVE	DATE	SHEET	3/4	0.5mmB0 TO B0 SOCKET SMT, H=3.25, ASSEMBLY
				Angle ± 3°			PROJ.	⊕	Customer NO.
				DIM TOL					



Http: www.wcon.com

WCON-Dongguan Tel: +86 769 85358920 Fax: +86 769 85358915 E-mail: sales@wcon.com	WCON-Kunshan Tel: +86 512 57468408 Fax: +86 512 57468468 E-mail: salesks@wcon.com
---	--

HSF

RECOMMENDED PCB LAYOUT (COMPONENT SIDE)
TOLERANCE ±0.05

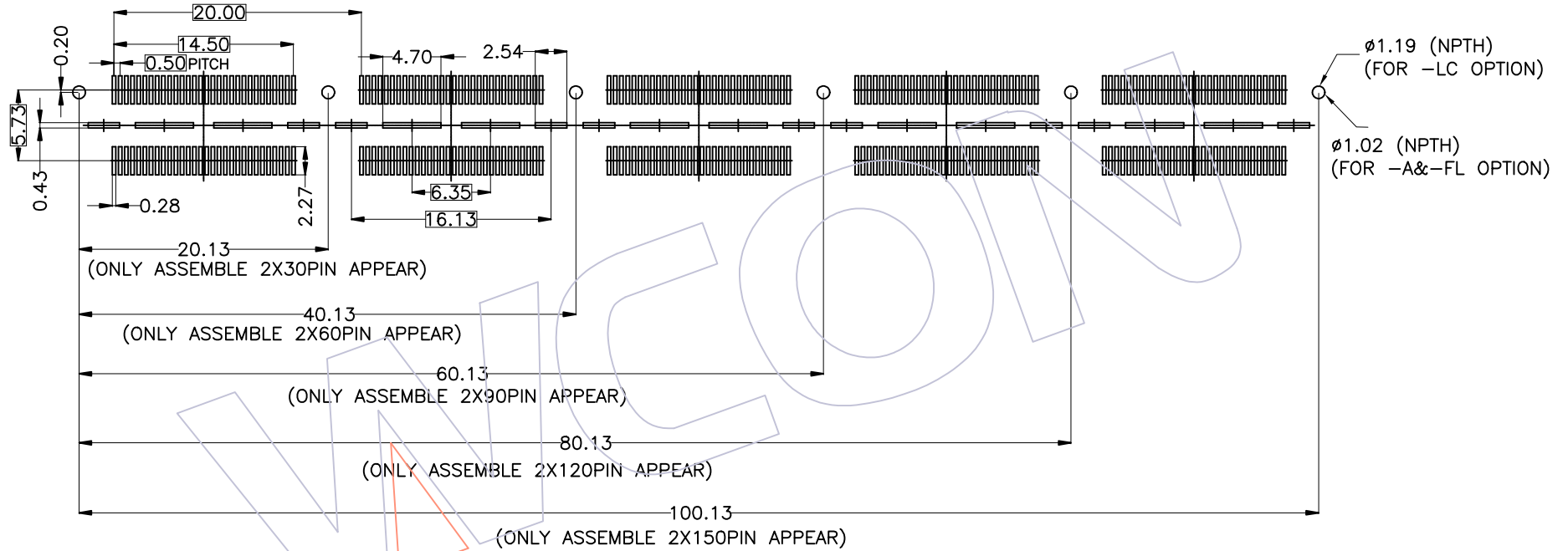

REV	DATE	MODIFICATION DESCRIPTION	CHANGE	OPERATION	DRAW	DATE	SCALE	Fit	PART NO.
A0	2022.04.06	NEW	—	x.x ±0.40	Abt Chen	2022.04.06	UNIT	mm	3720X-SMXXX-032XXX01
				x.xx ±0.25	CHECK	DATE	SIZE	A4	TITLE:
				x.xxx ±0.15	APPROVE	DATE	SHEET	4/4	0.5mmB0 TO B0 SOCKET SMT, H=3.25, ASSEMBLY
				Angle ± 3°			PROJ.	⌀	Customer NO.
				DIM TOL					

WCON

Http: www.wcon.com

WCON-Dongguan Tel: +86 769 85358920 Fax: +86 769 85358915 E-mail: sales@wcon.com	WCON-Kunshan Tel: +86 512 57468408 Fax: +86 512 57468468 E-mail: salesks@wcon.com
---	--