

HSF

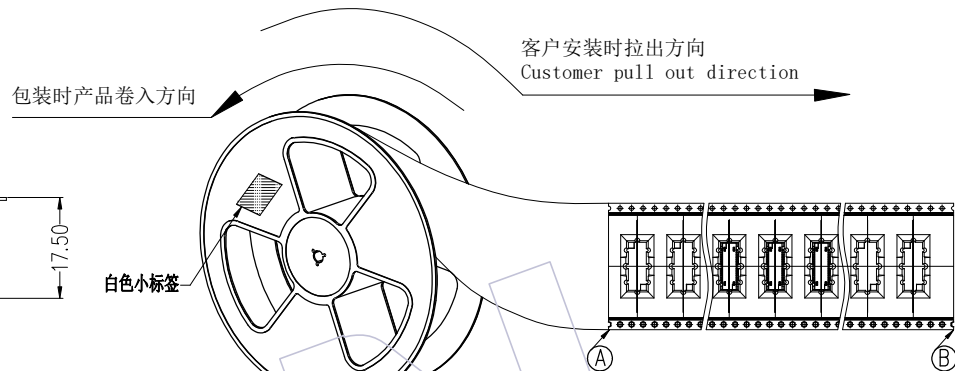

No.1:
产品包装前,注意载带要留空160mm以上
将产品放入载带凹槽后,用盖带封装,
注意:盖带与承载带的拉力30g-120g

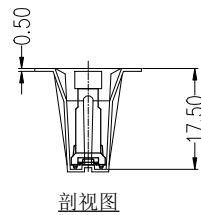
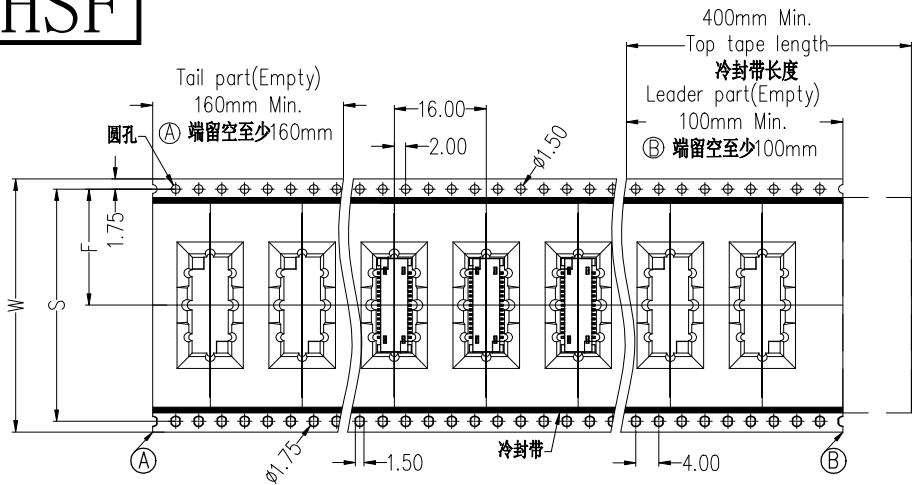
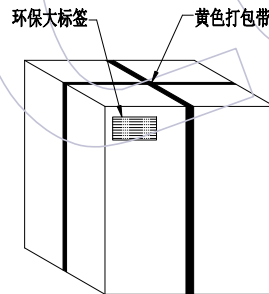

外箱: CTN-18K

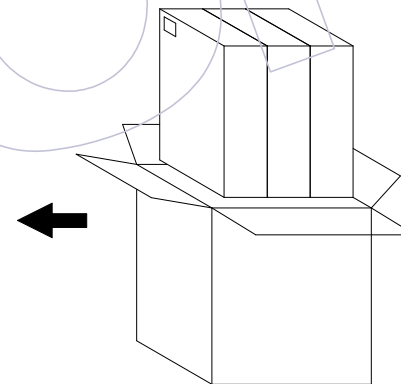

No.2:
将内箱装入外箱(3内箱/外箱)
注意统一标签方向

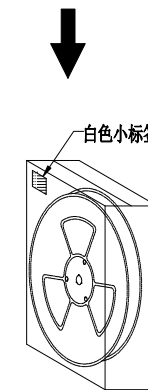

内箱: CTN-18E

No.3:
将卷盘套上防水袋,
放入1包干燥剂,
真空机封口后装入内箱,
用封箱胶封装好,并贴上标签。

No.4:
封箱, 打包, 贴标签。

PIN	载带料号	W	S	F	PCS/Reel	PCS/内箱	PCS/外箱
30	TR3618-MN030M16801	44.0±0.30	40.40±0.15	20.20±0.15	210	420	1260
50	TR3618-MN050M16801	56.0±0.30	52.40±0.15	26.20±0.15	210	420	1260
80	TR3618-MN080M16801	72.0±0.30	68.40±0.15	34.20±0.15	210	210	630

变更 记录	A0	2022/10/28	NEW	-----	-----	工程图 ENGINEERING	绘图 DRAW	苏珊	2022/10/28	SCALE	FIT	 WCON ELECTRONICS (GUANGDONG) CO., LTD 料号 PART NO. 3618-PXXX-158MXXR01 品名 TITLE: 0.8mm BTB直立式公座, SMT Type XXP W/T CAP H=15.80mm 卷装规范
	版次 REV	日期 DATE	变更说明 MODIFICATION DESCRIPTION	变更 CHANGE	核准 APPROVE	X.X	±0.30	设计 DESIGN		UNIT	mm	
						X.XX	±0.20	审核 CHECK		SIZE	A4	
						X.XXX	±0.10	核准 APPROVE		SHEET	1/1	
						Angle	± 2'			PROJ.		