

HSF

NOTES:
 Current Rating: 7.0AMP
 Contact Resistance: 30mΩ Max
 Withstand Voltage: 1000V AC/DC
 Insulation Resistance: 1000MΩ Min
 Operation Temperature: -40°C to +105°C

Contact Material: Phosphor Bronze
 Contact plating: Sn over Ni
 Insulator Material: LCP+30%G.F UL94V-0

Recommended P.C.B Layout(Top Side)
 (PCB BOARD TOLERANCE ±0.05)

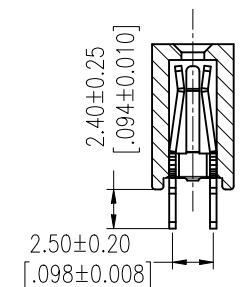
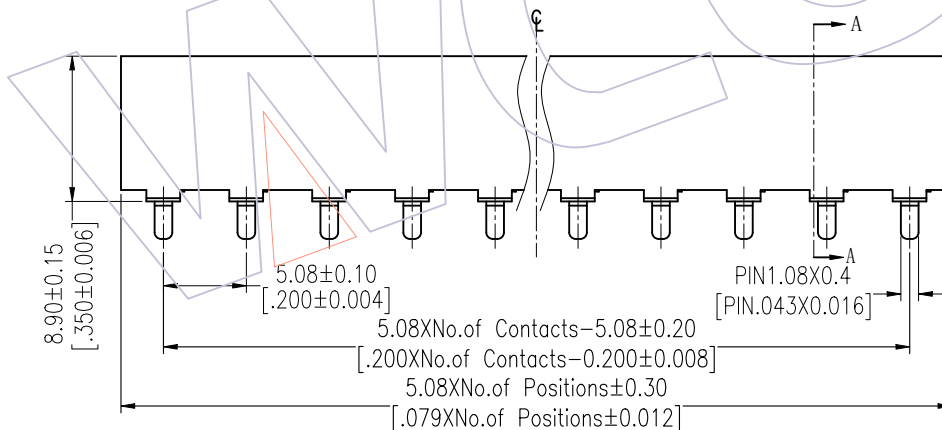
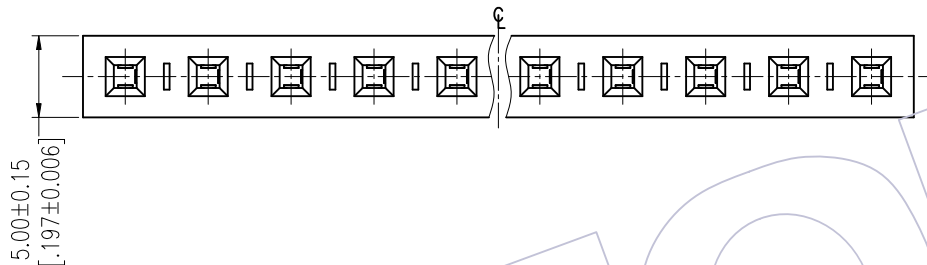
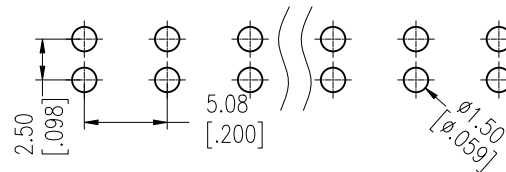

Ordering Information

2989 - 1 XX S XX D U N T 1

No. of Pins per ROW: 02-20PIN
 A1

Contact Plating:
 SN=Tin
 SM=Matte Tin

Packing:
 T=Tube

Item	Pitch	Mating
Standard	5.08	1925
Alternate		

REV	DATE	MODIFICATION DESCRIPTION	CHANGE	OPERATION	DRAW	DATE	SCALE	FIT	PART NO.
A1	2017/06/08	MODIFY	-----	x.x ±0.40	Surong Xu	2017/06/08	UNIT mm		2989-1XXSXXDUNT1
A0	2012/08/15	NEW	-----	x.xx ±0.25	CHECK	DATE	SIZE A4		TITLE: FH5.08 SINGLE ROW 180°DIP H=8.9
				x.xxx ±0.15	APPROVE	DATE	SHEET 1/1		Customer NO.
				Angle ± 3'			PROJ.		
				DIM TOL					

WCON

Http: www.wcon.com

WCON-Dongguan	WCON-Kunshan
Tel: +86 769 85358920	Tel: +86 512 57468408
Fax: +86 769 85358915	Fax: +86 512 57468468
E-mail: sales@wcon.com	E-mail: salesks@wcon.com