

# HSF

## TECHNICAL SPECS:

Current Rating: 3.0AMP  
 Contact Resistance: 10mΩ Max  
 Dielectric Strength: Min 1000Vrms  
 Mechanical Life: Min 500 cycles  
 Mating Pin: Ø0.40 to Ø0.56mm  
 Forces: (polished steel gauge Ø0.47mm)  
 Insertion: 200g Max/Pin, Withdrawal: 60g Min/Pin  
 Operation Temperature: -40°C to +105°C

Sleeve: Brass CuZn36Pb3(C36000)  
 Contact Clip(4 finger): BeCu(C17200)  
 Insulator Material: PPS+30%G.F(UL94V-0)

## Ordering Information

3520-301 XX M XX 042 X 1

|                       |   |  |
|-----------------------|---|--|
| No. of Pin<br>2~50PIN | Contact Plating<br>S0=Gold Flash/Tin<br>S3=10u"Gold/Tin<br>S4=15u"Gold/Tin<br>S5=30u"Gold/Tin<br>SN=Tin | Packing<br>A=Tray<br>T=Tube<br>R=Reel&Tape |
|-----------------------|---|--|

Recommended P.C.B Layout(Top Side)  
 (PCB BOARD TOLERANCE ±0.05)

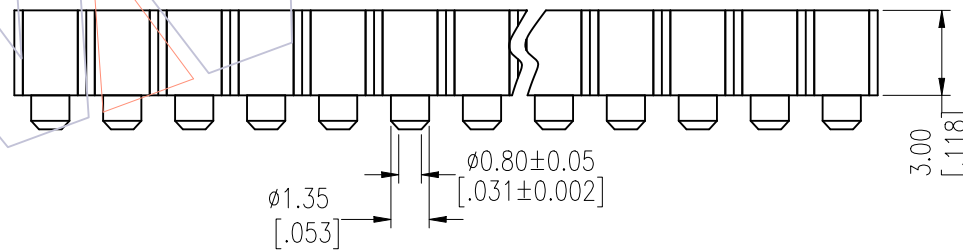
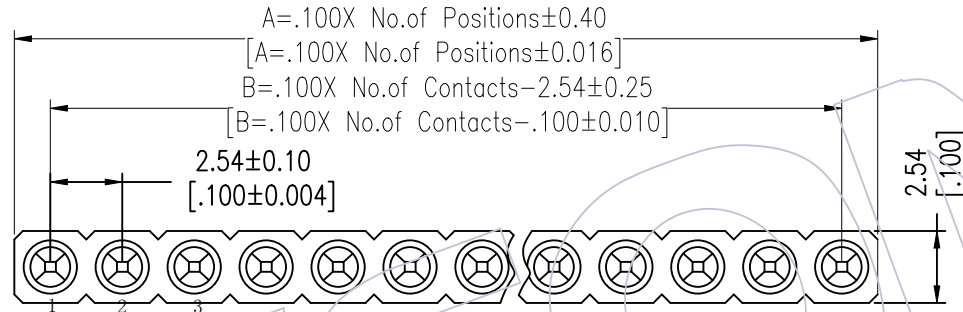
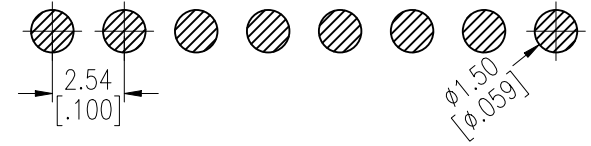

| Item      | Pitch | Mating |
|-----------|-------|--------|
| Standard  | 2.54  | 3510   |
| Alternate |       |        |

| REV | DATE       | MODIFICATION DESCRIPTION | CHANGE | OPERATION |       | DRAW    | DATE       | SCALE | FIT | PART NO.   |
|-----|------------|--------------------------|--------|-----------|-------|---------|------------|-------|-----|--|
|     |            |                          |        | Angle     | TOL   |         |            |       |     |  |
| A0  | 2012/10/18 | NEW                      | -----  | x.x       | ±0.40 | JYHuang | 2012/10/18 | UNIT  | mm  | 3520-301XXMX042X1  |
|     |            |                          |        | x.xx      | ±0.25 | CHECK   | DATE       | SIZE  | A4  | TITLE:<br>2.54mm MACHINED FEMALE HEADER<br>SINGLE ROW SMT H=3.00 L=4.2 |
|     |            |                          |        | x.xxx     | ±0.15 | APPROVE | DATE       | SHEET | 1/1 | Customer NO.   |
|     |            |                          |        | DIM       | TOL   |         |            | PROJ. |     |  |

# WCON

Http: www.wcon.com

|                        |                          |
|------------------------|--------------------------|
| WCON-Dongguan          | WCON-Kunshan             |
| Tel: +86 769 85358920  | Tel: +86 512 57468408    |
| Fax: +86 769 85358915  | Fax: +86 512 57468468    |
| E-mail: sales@wcon.com | E-mail: salesks@wcon.com |