

HSF

Recommended P.C.B Layout(Top Side)
(PCB BOARD TOLERANCE±0.05)

NOTES:
 Current Rating: 2.0AMP
 Contact Resistance: 20mΩ Max
 Withstand Voltage: 500V AC/DC
 Insulation Resistance: 1000MΩ Min
 Operation Temperature: -40°C to +105°C

Contact Material:Brass
 Contact plating:Au Or Sn over Ni
 Insulator Material:LCP+30%G.F UL94V-0

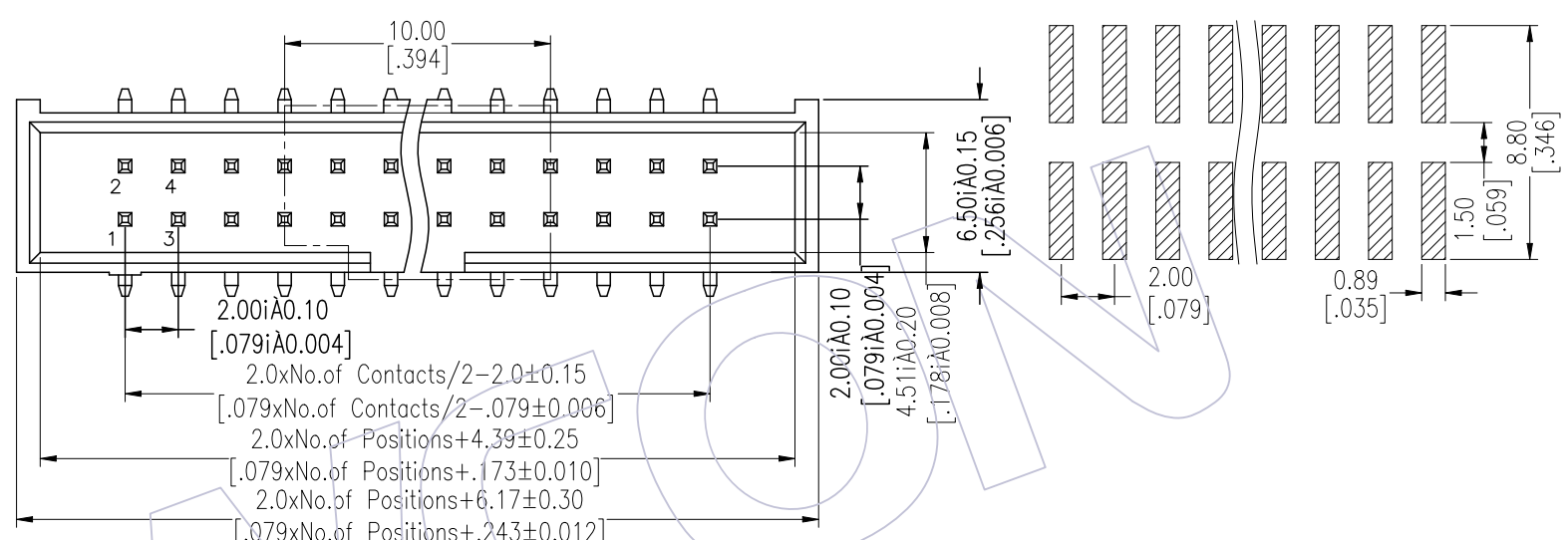

Ordering Information

3124-XX M XX B K00 X 1

No.of Pins	Contact Plating	Color Insulator	Packing
10 30	G0=Gold Flash	B=Black	T=Tube
14 34	G3=10u"Gold	W=White	P=Tube+CAP
16 40	G4=15u"Gold		R=Tape&Reel+CAP
20 44	G5=30u"Gold		
24 50	S0=Gold Flash/Tin		
26 60	S3=10u"Gold/Tin		
	S4=15u"Gold/Tin		
	S5=30u"Gold/Tin		
	SN=Tin		

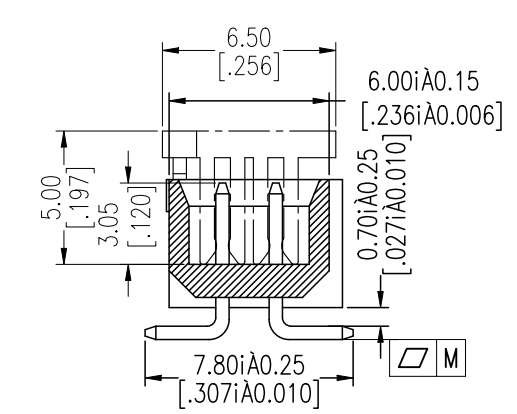
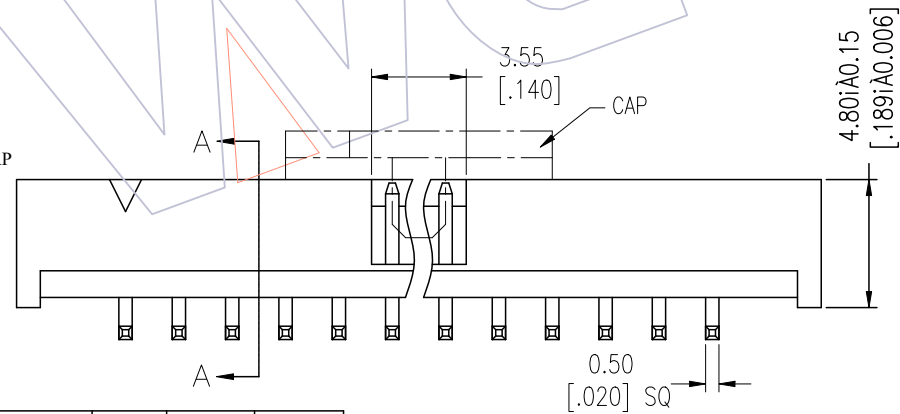

Item	Pitch	Mating
Standard	2.00	5225
Alternate		

△	PIN(PerRow)	10-20P	24-40P	44-60P
		M	0.10	0.12

REV	DATE	MODIFICATION DESCRIPTION	CHANGE	OPERATION	DRAW	DATE	SCALE	FIT	PART NO.
A1	2023/02/16	Add Flatness	DuYing	x.x ±0.40	DuYing	2023/02/16	UNIT mm		3124-XXMXXBK00X1
A0	2012/09/24	NEW	JYHuang	x.xx ±0.25	CHECK	DATE	SIZE A4		TITLE: 2.00 BOX HEADER SMT H=4.8 SAMTEC (LONG TYPE)
				x.xxx ±0.15	APPROVE	DATE	SHEET 1/1		Customer NO.
				Angle ± 3°			PROJ.		
				DIM TOL					

WCON
 Http: www.wcon.com
 WCON-Dongguan WCON-Kunshan
 Tel: +86 769 85358920 Tel: +86 512 57468408
 Fax: +86 769 85358915 Fax: +86 512 57468468
 E-mail: sales@wcon.com E-mail: salesks@wcon.com