

HSF

NOTES:

Voltage Rating: 50V AC/DC
 Current Rating: 0.5AMP
 Contact Resistance: 20mΩ max
 Withstand Voltage: 500V AC/Minute
 Insulation Resistance: 500MΩ min
 Operation Temperature: -40°C to +105°C

Contact Material: Phosphor Bronze
 Contact Plating: Sn OR Au OVER Nickel
 Insulator Material: PA9T+33%GF UL94V-0 BLACK

Ordering Information

3651 - S XXX - 042 XX ROX

No. of Pins
 006: 06 Pin
 010: 10 Pin
 012: 12 Pin
 014: 14 Pin
 016: 16 Pin
 018: 18 Pin
 020: 20 Pin
 022: 22 Pin
 024: 24 Pin

Plating
 G0=Gold Flash
 G3=10u"Gold
 G4=15u"Gold
 G5=30u"Gold
 S0=Gold Flash/Tin
 S3=10u"Gold/Tin
 S4=15u"Gold/Tin
 S5=30u"Gold/Tin
 SN=Tin

Packing
 R=Tape & Reel

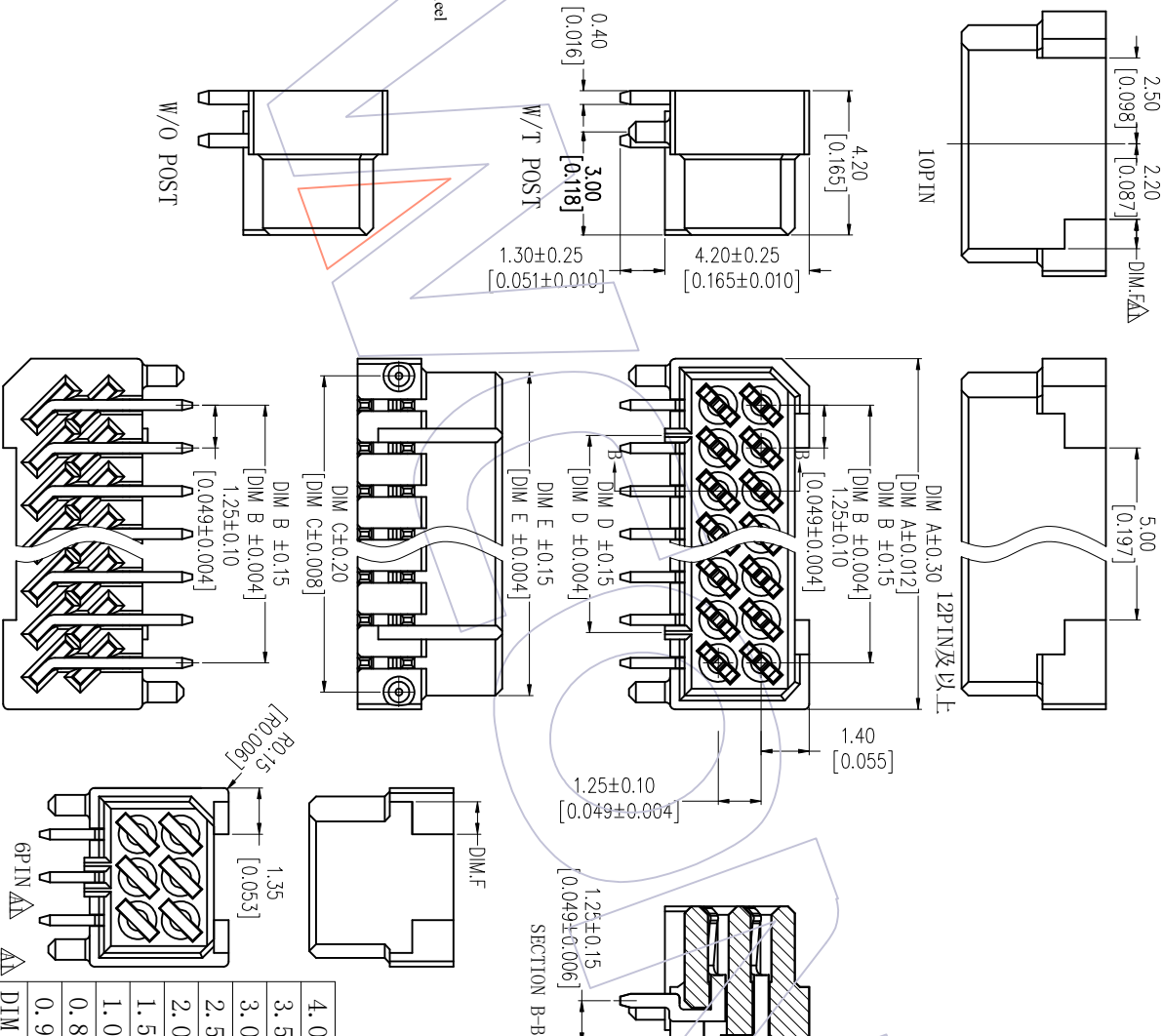

Recommended P.C.B Layout (Top Side)
 (PCB BOARD TOLERANCE ±0.05)

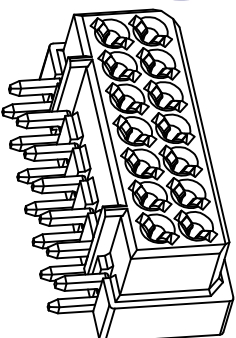
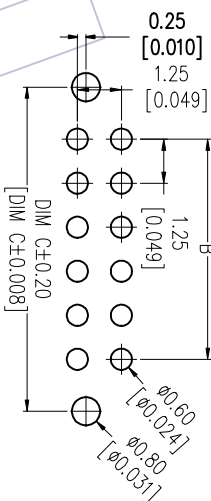

3651-SXXX-042XXXR04	W/O POST
3651-SXXX-042XXXR03	W/T POST

4.00	15.65	11.99	15.45	13.75	16.45	24
3.50	14.40	10.74	14.20	12.50	15.20	22
3.00	13.15	9.49	12.95	11.25	13.95	20
2.50	11.90	8.24	11.70	10.00	12.70	18
2.00	10.65	6.99	10.45	8.75	11.45	16
1.50	9.40	5.74	9.20	7.50	10.20	14
1.00	8.15	4.49	7.95	6.25	8.95	12
0.85	6.90	3.24	6.70	5.00	7.70	10
0.95	4.40	0.74	4.20	2.50	5.20	6

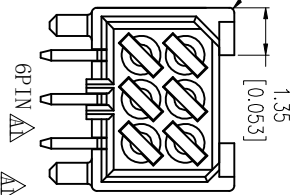

REV	DATE	MODIFICATION DESCRIPTION	CHANGE	OPERATION	DRAW	DATE	SCALE	FIT	PART NO.	TITLE:	Customer NO.	WCON-Dongguan	WCON-Kunshan
A1	2017.12.19	Modify	---	XX	Dwg	2017.12.19	mm	A4	3651-SXXX-042XXXR0X	1.25mm BTB FEMALE, 90° DIP TYPE		+86 769 85358920	+86 512 57468408
A0	2016.10.20	NEW	---	X.XXX	CHECK		mm	A4				+86 769 85358915	+86 512 57468468
				Angle	APPROVE	DATE	SHEET	1/1				E-mail: sales@wcon.com	E-mail: sales@wcon.com
				± 3'			PROJ.						



Http: www.wcon.com