

HSF

NOTES:

Rated Current: 1.5AMP.(20°C,2*2P-2*15P)
 1.0AMP.(20°C,2*16P-2*50P) $\Delta A4$
 Contact Resistance: 20mΩ Max.
 Withstand Voltage: 500V AC/DC
 Insulation Resistance: 1000MΩ Min. $\Delta A4$
 Operation Temperature: -40°C to +125°C(Gold Plating)
 -40°C to +105°C(Tin Plating)
 Contact Material: Copper Alloy
 Contact Plating: Au or Sn Over 30u" Min Ni $\Delta A4$
 Insulator Material: PA9T+G.F UL94V-0 BK $\Delta A4$

Ordering Information

1325-1 2 XX XX Z XXX C X XX $\Delta A4$

Plastic Layer
 Plastic Row
 No. of Pins Per Row: 02-50
 Contact Plating
 G0=Gold Flash
 G3=10u"Au, BG3=8u"PdNi+2u"Au
 G4=15u"Au, BG4=13u"PdNi+2u"Au
 G5=30u"Au, BG5=28u"PdNi+2u"Au
 S0=Gold Flash/Tin
 S3=10u"Au/Sn, P3=8u"PdNi+2u"Au/Sn
 S4=15u"Au/Sn, P4=13u"PdNi+2u"Au/Sn
 S5=30u"Au/Sn, P5=28u"PdNi+2u"Au/Sn
 SN=Bright Tin
 SM=Matte Tin

Series No. 01-99
 Packing T=Tube P=Tube+CAP R=Tape&Reel+CAP
 Insulator Material C=PA9T(Standard)
 Pin Length L(See Table)
 Type: Z=R/A SMT

Item	Pin Length	A	A	B	Mating
Standard	7.0/10.3	2.4	5.2	2.0	2321/2320T
	8.0/11.3			3.0	2334/2344/2346
	8.5/11.8			3.5	2357
	9.5/12.8			4.5	2345/2385
Alternate					

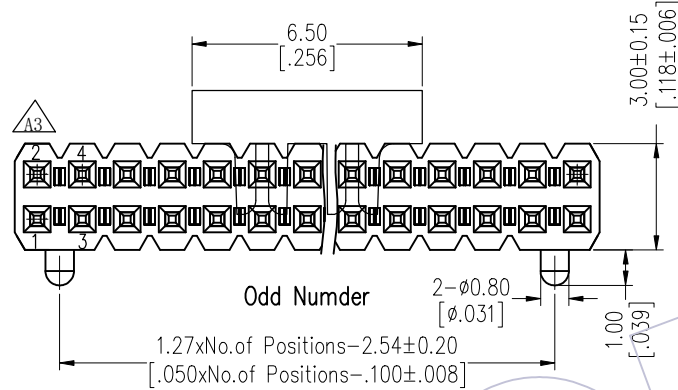

Recommended P.C.B Layout (Top Side)
 (PCB BOARD TOLERANCE±0.05)
 (PCB Thickness:T=1.60m)

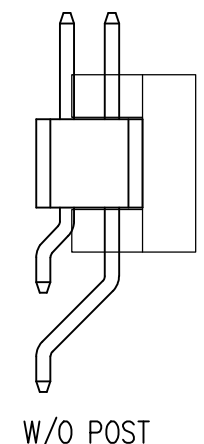
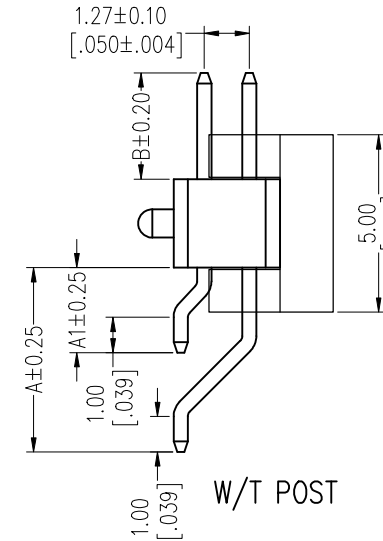
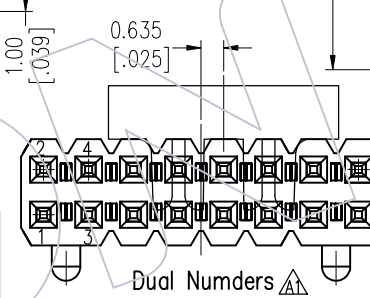
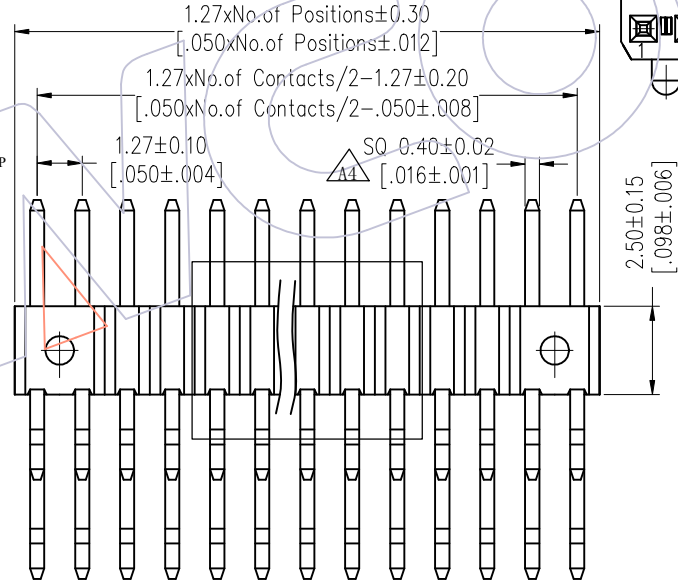
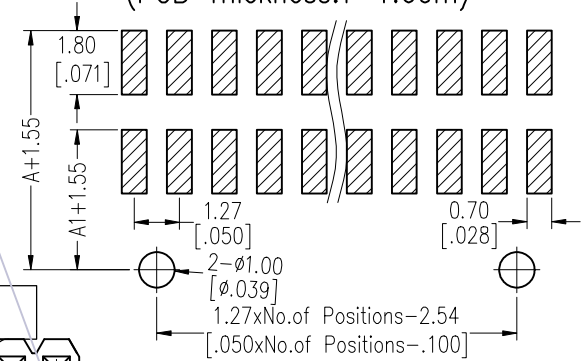

REV	DATE	MODIFICATION DESCRIPTION	CHANGE	DIM	TOL	APPROVE	DATE	PROJ.	PART NO.	Fit	Customer NO.
A4	2025/09/15	Standardization Drawing	CP			STEVEN ZHAO	2025/09/15		1325-12XXXXZXXXCXXX $\Delta A4$	A4	
A3	2024/01/24	Modify Drawing	William Chen	x.x	±0.40	CP	2025/09/15				
A2	2018/01/18	MODIFY PART NO.	William Chen	x.xx	±0.25	CHECK	2025/09/15				
A0	2012/03/31	NEW	William Chen	x.xxx	±0.15	TANG	2025/09/15				
				Angle	± 3°	APPROVE	2025/09/15				
						STEVEN ZHAO	2025/09/15				

WCON
 Http: www.wcon.com

WCON-Dongguan Tel: +86 769 85358920 Fax: +86 769 85358915 E-mail: sales@wcon.com

WCON-Kunshan Tel: +86 512 57468408 Fax: +86 512 57468468 E-mail: salesks@wcon.com

HSF

Packing:

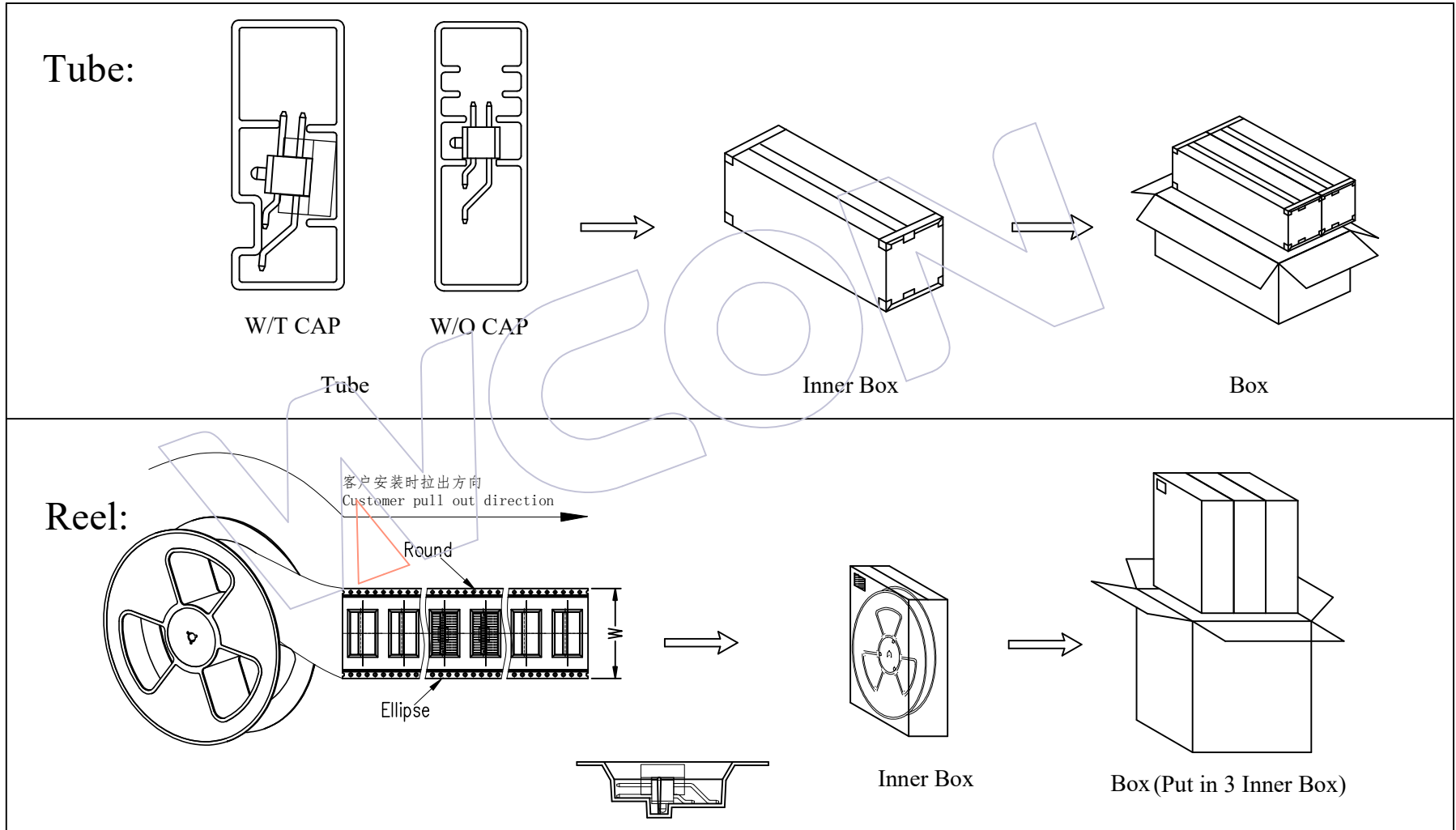

A4	2025/09/15	Standardization Drawing	CP	OPERATION	DRAW	DATE	SCALE	Fit	PART NO. 1325-12XXXXXXCXXX
A3	2024/01/24	Modify Drawing	William Chen	X.X ±0.40	CP	2025/09/15	UNIT	mm [inch]	
A2	2018/01/18	MODIFY PART NO.	William Chen	X.XX ±0.25	CHECK	DATE	SIZE	A4	
A0	2012/03/31	NEW	William Chen	X.XXX ±0.15	TANG	2025/09/15	SHEET	2/5	
REV	DATE	MODIFICATION DESCRIPTION	CHANGE	Angle ± 3° DIM TOL	APPROVE Steven Zhao	DATE 2025/09/15	PROJ.		
									TITLE: 1.27 Pin Header, DUAL ROW, R/A&SMT,H=2.5
									Customer NO.

WCON
Http: www.wcon.com

WCON-Dongguan Tel: +86 769 85358920 Fax: +86 769 85358915 E-mail: sales@wcon.com	WCON-Kunshan Tel: +86 512 57468408 Fax: +86 512 57468468 E-mail: sales@wcon.com
---	--



Packaging Quantity Refers To The Following Table

W/O CAP

PINS /Row	Q' ty/Tube	Q' ty/Inner Box	Q' ty/Box
4	107	14,124	28,248
5	91	12,012	24,024
6	73	9,636	19,272
7	65	8,580	17,160
8	58	7,656	15,312
9	49	6,468	12,936
10	45	5,940	11,880
11	40	5,280	10,560
12	37	4,884	9,768
13	34	4,488	8,976
14	32	4,224	8,448
15	30	3,960	7,920
16	28	3,696	7,392
17	26	3,432	6,864
18	25	3,300	6,600
19	23	3,036	6,072
20	22	2,904	5,808
21	21	2,772	5,544
22	20	2,640	5,280
23	19	2,508	5,016
24	18	2,376	4,752
25	18	2,376	4,752
26	17	2,244	4,488
27	16	2,112	4,224

W/O CAP

PINS /Row	Q' ty/Tube	Q' ty/Inner Box	Q' ty/Box
28	16	2,112	4,224
29	15	1,980	3,960
30	15	1,980	3,960
31	14	1,848	3,696
32	14	1,848	3,696
33	13	1,716	3,432
34	13	1,716	3,432
35	12	1,584	3,168
36	12	1,584	3,168
37	12	1,584	3,168
38	11	1,452	2,904
39	11	1,452	2,904
40	11	1,452	2,904
41	11	1,452	2,904
42	10	1,320	2,640
43	10	1,320	2,640
44	10	1,320	2,640
45	10	1,320	2,640
46	9	1,188	2,376
47	9	1,188	2,376
48	9	1,188	2,376
49	9	1,188	2,376
50	9	1,188	2,376

W/T CAP

PINS /Row	Q' ty/Tube	Q' ty/Inner Box	Q' ty/Box
4	88	10,560	21,120
5	88	10,560	21,120
6	73	8,760	17,520
7	65	7,800	15,600
8	58	6,960	13,920
9	49	5,880	11,760
10	45	5,400	10,800
11	40	4,800	9,600
12	37	4,440	8,880
13	34	4,080	8,160
14	32	3,840	7,680
15	30	3,600	7,200
16	28	3,360	6,720
17	26	3,120	6,240
18	25	3,000	6,000
19	23	2,760	5,520
20	22	2,640	5,280
21	21	2,520	5,040
22	20	2,400	4,800
23	19	2,280	4,560
24	18	2,160	4,320
25	18	2,160	4,320
26	17	2,040	4,080
27	16	1,920	3,840

W/T CAP

PINS /Row	Q' ty/Tube	Q' ty/Inner Box	Q' ty/Box
28	16	1,920	3,840
29	15	1,800	3,600
30	15	1,800	3,600
31	14	1,680	3,360
32	14	1,680	3,360
33	13	1,560	3,120
34	13	1,560	3,120
35	12	1,440	2,880
36	12	1,440	2,880
37	12	1,440	2,880
38	11	1,320	2,640
39	11	1,320	2,640
40	11	1,320	2,640
41	11	1,320	2,640
42	10	1,200	2,400
43	10	1,200	2,400
44	10	1,200	2,400
45	10	1,200	2,400
46	9	1,080	2,160
47	9	1,080	2,160
48	9	1,080	2,160
49	9	1,080	2,160
50	9	1,080	2,160

A4	2025/09/15	Standardization Drawing	CP	OPERATION	DRAW	DATE	SCALE	Fit	PART NO.
A3	2024/01/24	Modify Drawing	William Chen	x.X ±0.40	CP	2025/09/15	UNIT	mm [inch]	1325-12XXXXZXXCXXX
A2	2018/01/18	MODIFY PART NO.	William Chen	x.xx ±0.25	CHECK	DATE	SIZE	A4	TITLE:
A0	2012/03/31	NEW	William Chen	x.xxx ±0.15	TANG	2025/09/15	SHEET	3/5	1.27 Pin Header, DUAL ROW, R/A&SMT, H=2.5
REV	DATE	MODIFICATION DESCRIPTION	CHANGE	Angle ± 3°	APPROVE	DATE	PROJ.		Customer NO.
				DIM TOL	Steven Zhao	2025/09/15			

Http: www.wcon.com

WCON-Dongguan Tel: +86 769 85358920 Fax: +86 769 85358915 E-mail: sales@wcon.com	WCON-Kunshan Tel: +86 512 57468408 Fax: +86 512 57468468 E-mail: salesks@wcon.com
---	--

HSF

Packaging Quantity Refers To The Following Table

B=2.0

B=2.0

B=3.0

B=3.0

PINS /Row	W	Q' ty/Reel	Q' ty/Inner Box	Q' ty/Box
2	12	650	3,900	11,700
3	16	650	2,600	7,800
4	16	650	2,600	7,800
5	16	650	2,600	7,800
6	24	650	1,950	5,850
7	24	650	1,950	5,850
8	24	650	1,950	5,850
9	24	650	1,950	5,850
10	24	650	1,950	5,850
11	24	650	1,950	5,850
12	32	650	1,300	3,900
13	32	650	1,300	3,900
14	32	650	1,300	3,900
15	32	650	1,300	3,900
16	44	650	1,300	3,900
17	44	650	1,300	3,900
18	44	650	1,300	3,900
19	44	650	1,300	3,900
20	44	650	1,300	3,900
21	44	650	1,300	3,900
22	44	650	1,300	3,900
23	44	650	1,300	3,900
24	44	650	1,300	3,900
25	44	650	1,300	3,900
26	56	650	650	1,950

PINS /Row	W	Q' ty/Reel	Q' ty/Inner Box	Q' ty/Box
27	56	650	650	1,950
28	56	650	650	1,950
29	56	650	650	1,950
30	56	650	650	1,950
31	56	650	650	1,950
32	56	650	650	1,950
33	56	650	650	1,950
34	56	650	650	1,950
35	72	650	650	1,950
36	72	650	650	1,950
37	72	650	650	1,950
38	72	650	650	1,950
39	72	650	650	1,950
40	72	650	650	1,950
41	72	650	650	1,950
42	72	650	650	1,950
43	72	650	650	1,950
44	72	650	650	1,950
45	72	650	650	1,950
46	72	650	650	1,950
47	72	650	650	1,950
48	88	650	650	1,950
49	88	650	650	1,950
50	88	650	650	1,950

PINS /Row	W	Q' ty/Reel	Q' ty/Inner Box	Q' ty/Box
2	12	700	4,200	12,600
3	16	700	2,800	8,400
4	16	700	2,800	8,400
5	16	700	2,800	8,400
6	24	700	2,100	6,300
7	24	700	2,100	6,300
8	24	700	2,100	6,300
9	24	700	2,100	6,300
10	24	700	2,100	6,300
11	24	700	2,100	6,300
12	32	700	1,400	4,200
13	32	700	1,400	4,200
14	32	700	1,400	4,200
15	32	700	1,400	4,200
16	44	700	1,400	4,200
17	44	700	1,400	4,200
18	44	700	1,400	4,200
19	44	700	1,400	4,200
20	44	700	1,400	4,200
21	44	700	1,400	4,200
22	44	700	1,400	4,200
23	44	700	1,400	4,200
24	44	700	1,400	4,200
25	44	700	1,400	4,200
26	56	700	700	2,100

PINS /Row	W	Q' ty/Reel	Q' ty/Inner Box	Q' ty/Box
27	56	700	700	2,100
28	56	700	700	2,100
29	56	700	700	2,100
30	56	700	700	2,100
31	56	700	700	2,100
32	56	700	700	2,100
33	56	700	700	2,100
34	56	700	700	2,100
35	72	700	700	2,100
36	72	700	700	2,100
37	72	700	700	2,100
38	72	700	700	2,100
39	72	700	700	2,100
40	72	700	700	2,100
41	72	700	700	2,100
42	72	700	700	2,100
43	72	700	700	2,100
44	72	700	700	2,100
45	72	700	700	2,100
46	72	700	700	2,100
47	72	700	700	2,100
48	88	700	700	2,100
49	88	700	700	2,100
50	88	700	700	2,100

REV	DATE	MODIFICATION DESCRIPTION	CHANGE	DIM	TOL	APPROVE	DATE	PROJ.
A4	2025/09/15	Standardization Drawing	CP			DRAW	2025/09/15	
A3	2024/01/24	Modify Drawing	William Chen	x.X	±0.40	CP		
A2	2018/01/18	MODIFY PART NO.	William Chen	x.xx	±0.25	CHECK	2025/09/15	
A0	2012/03/31	NEW	William Chen	x.xxx	±0.15	TANG		
				Angle	± 3'	APPROVE	2025/09/15	
						Steven Zhao		

WCON
 Http: www.wcon.com

WCON-Dongguan
 Tel: +86 769 85358920
 Fax: +86 769 85358915
 E-mail: sales@wcon.com

WCON-Kunshan
 Tel: +86 512 57468408
 Fax: +86 512 57468468
 E-mail: salesks@wcon.com

PART NO. 1325-12XXXXZXXCXXX

TITLE: 1.27 Pin Header, DUAL ROW, R/A&SMT, H=2.5

Customer NO.

HSF

Packaging Quantity Refers To The Following Table

B=3.5/4.5

B=3.5/4.5

PINS /Row	W	Q' ty/Reel	Q' ty/Inner Box	Q' ty/Box	PINS /Row	W	Q' ty/Reel	Q' ty/Inner Box	Q' ty/Box
2	12	500	3,000	9,000	27	56	500	500	1,500
3	16	500	2,000	6,000	28	56	500	500	1,500
4	16	500	2,000	6,000	29	56	500	500	1,500
5	16	500	2,000	6,000	30	56	500	500	1,500
6	24	500	1,500	4,500	31	56	500	500	1,500
7	24	500	1,500	4,500	32	56	500	500	1,500
8	24	500	1,500	4,500	33	56	500	500	1,500
9	24	500	1,500	4,500	34	56	500	500	1,500
10	24	500	1,500	4,500	35	72	500	500	1,500
11	24	500	1,500	4,500	36	72	500	500	1,500
12	32	500	1,000	3,000	37	72	500	500	1,500
13	32	500	1,000	3,000	38	72	500	500	1,500
14	32	500	1,000	3,000	39	72	500	500	1,500
15	32	500	1,000	3,000	40	72	500	500	1,500
16	44	500	1,000	3,000	41	72	500	500	1,500
17	44	500	1,000	3,000	42	72	500	500	1,500
18	44	500	1,000	3,000	43	72	500	500	1,500
19	44	500	1,000	3,000	44	72	500	500	1,500
20	44	500	1,000	3,000	45	72	500	500	1,500
21	44	500	1,000	3,000	46	72	500	500	1,500
22	44	500	1,000	3,000	47	72	500	500	1,500
23	44	500	1,000	3,000	48	88	500	500	1,500
24	44	500	1,000	3,000	49	88	500	500	1,500
25	44	500	1,000	3,000	50	88	500	500	1,500
26	56	500	500	1,500					

A4	2025/09/15	Standardization Drawing	CP	OPERATION	DRAW	DATE	SCALE	Fit	PART NO.
A3	2024/01/24	Modify Drawing	William Chen	x.X ±0.40	CP	2025/09/15	UNIT	mm [inch]	1325-12XXXXZXXCXXX
A2	2018/01/18	MODIFY PART NO.	William Chen	x.xx ±0.25	CHECK	DATE	SIZE	A4	TITLE:
A0	2012/03/31	NEW	William Chen	x.xxx ±0.15	TANG	2025/09/15	SHEET	5/5	1.27 Pin Header, DUAL ROW, R/A&SMT, H=2.5
REV	DATE	MODIFICATION DESCRIPTION	CHANGE	Angle ± 3°	APPROVE	DATE	PROJ.		Customer NO.
				DIM TOL	Steven Zhao	2025/09/15			

WCON
 Http: www.wcon.com

WCON-Dongguan Tel: +86 769 85358920
 Fax: +86 769 85358915
 E-mail: sales@wcon.com

WCON-Kunshan Tel: +86 512 57468408
 Fax: +86 512 57468468
 E-mail: salesks@wcon.com