

HSF

NOTES: $\triangle A1$

Rated Current: 1.5AMP.(20°C, 2*2P-2*15P)

1.0AMP.(20°C, 2*16P-2*50P)

Contact Resistance: 20mΩ Max.

Withstand Voltage: 500V AC/DC

Insulation Resistance: 1000MΩ Min.

Operation Temperature: -40°C to +125°C(Gold Plating)

Contact Material: Copper Alloy

Contact Plating: Au Over 30u" Min Ni

Insulator Material: PA9T+G.F UL94V-0 BK

Recommended P.C.B Layout(Top Side)
(PCB BOARD TOLERANCE±0.05)
(PCB Thickness:T=1.60m)

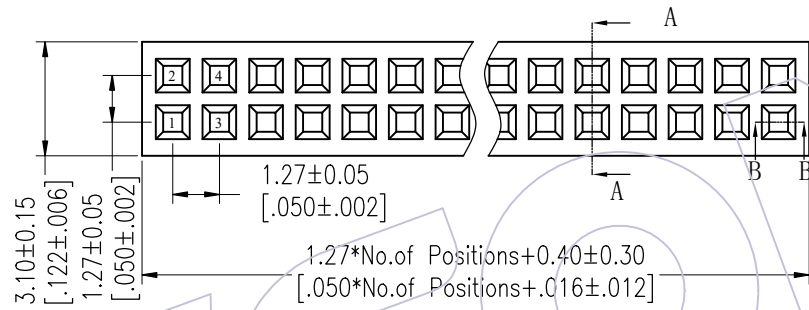
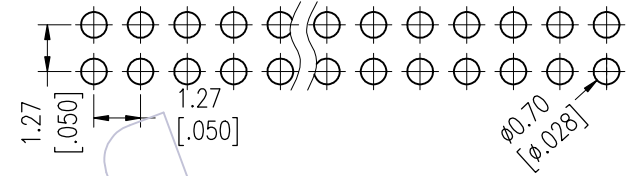

Ordering Information $\triangle A1$

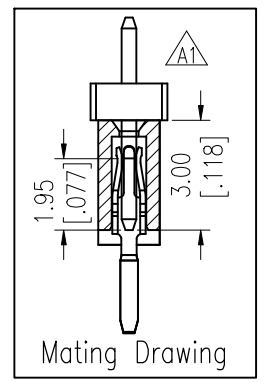
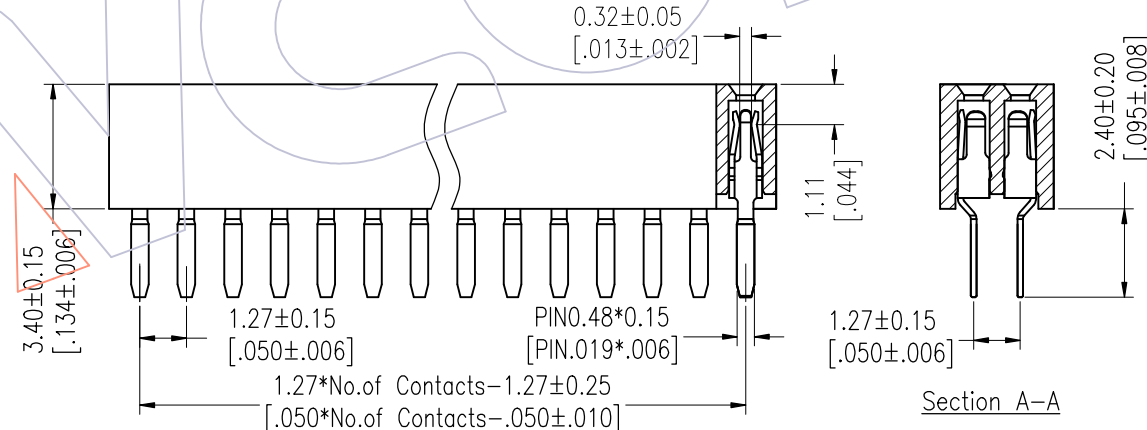
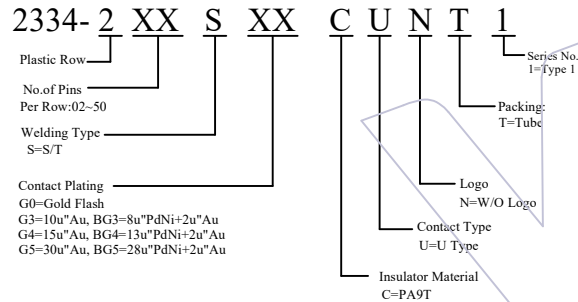

Item	Pitch	Mating	DIM.B
Standard	1.27	1310/1315/1320	3.00
Alternate			

REV	DATE	MODIFICATION DESCRIPTION	CHANGE	OPERATION	DRAW BAO	DATE	SCALE	FIT	PART NO.
A1	2026/01/28	Standardization Drawing	BAO	x.X ±0.40	CHECK TANG	2026/01/28	UNIT mm		2334-2XXSXXCUNT1
AO	2012/07/06	NEW	JYHuang	x.XX ±0.25	APPROVE Steven Zhao	2026/01/28	SIZE A4		TITLE: FH1.27 DUAL ROW 180° DIP, H=3.40
				x.XXX ±0.15			SHEET 1/2		Customer NO.
				Angle ± 3'			PROJ.		
				DIM TOL					

WCON
Http: www.wcon.com

WCON-Dongguan Tel: +86 769 85358920 Fax: +86 769 85358915 E-mail: sales@wcon.com

WCON-Kunshan Tel: +86 512 57468408 Fax: +86 512 57468468 E-mail: salesks@wcon.com

HSF

Packaging Quantity Refers To The Following Table

Packing: $\triangle A1$

Tube:

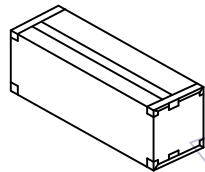
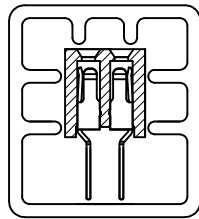

Inner Box

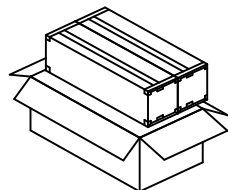

Box

PINS /Row	Q' ty/Tube	Q' ty/Inner Box	Q' ty/Box
2	800/Tray	/	38,400
3	137	32,880	65,760
4	105	25,200	50,400
5	85	20,400	40,800
6	72	17,280	34,560
7	62	14,880	29,760
8	54	12,960	25,920
9	49	11,760	23,520
10	44	10,560	21,120
11	40	9,600	19,200
12	36	8,640	17,280
13	34	8,160	16,320
14	31	7,440	14,880
15	29	6,960	13,920
16	28	6,720	13,440
17	26	6,240	12,480
18	24	5,760	11,520
19	23	5,520	11,040
20	22	5,280	10,560
21	21	5,040	10,080
22	20	4,800	9,600
23	19	4,560	9,120
24	18	4,320	8,640
25	18	4,320	8,640
26	17	4,080	8,160

PINS /Row	Q' ty/Tube	Q' ty/Inner Box	Q' ty/Box
27	16	3,840	7,680
28	16	3,840	7,680
29	15	3,600	7,200
30	15	3,600	7,200
31	14	3,360	6,720
32	14	3,360	6,720
33	13	3,120	6,240
34	13	3,120	6,240
35	12	2,880	5,760
36	12	2,880	5,760
37	12	2,880	5,760
38	11	2,640	5,280
39	11	2,640	5,280
40	11	2,640	5,280
41	10	2,400	4,800
42	10	2,400	4,800
43	10	2,400	4,800
44	10	2,400	4,800
45	10	2,400	4,800
46	9	2,160	4,320
47	9	2,160	4,320
48	9	2,160	4,320
49	9	2,160	4,320
50	9	2,160	4,320

REV	DATE	MODIFICATION DESCRIPTION	CHANGE	OPERATION		DRAW BAO	DATE	SCALE	FIT	PART NO.
				x.X	±0.40					
A1	2026/01/28	Standardization Drawing	BAO	x.XX	±0.25	CHECK TANG	2026/01/28	UNIT	mm	2334-2XXSXXCUNT1
AO	2012/07/06	NEW	JYHuang	x.XXX	±0.15	APPROVE Steven Zhao	2026/01/28	SIZE	A4	TITLE: FH1.27 DUAL ROW 180° DIP, H=3.40
				Angle	± 3'			SHEET	2/2	Customer NO.
				DIM	TOL			PROJ.		



Http: www.wcon.com

<p>WCON-Dongguan Tel: +86 769 85358920 Fax: +86 769 85358915 E-mail: sales@wcon.com</p>	<p>WCON-Kunshan Tel: +86 512 57468408 Fax: +86 512 57468468 E-mail: salesks@wcon.com</p>
---	--