

HSF

NOTES:

Rated Current: 1.5AMP.(20°C, 2*2P-2*15P)
1.0AMP.(20°C, 2*16P-2*50P)

Contact Resistance: 20mΩ Max.

Withstand Voltage: 500V AC/DC

Insulation Resistance: 1000MΩ Min.

Operation Temperature: -40°C to +125°C (Gold Plating)
-40°C to +105°C (Tin Plating)

Contact Material: Copper Alloy

Contact Plating: Au or Sn Over 30u" Min Ni

Insulator Material: PA9T+G.F UL94V-0 BK

Recommended P.C.B Layout (Top Side)
(PCB BOARD TOLERANCE ±0.05)
(PCB Thickness: T=1.60mm)

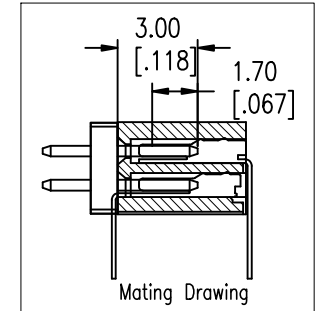
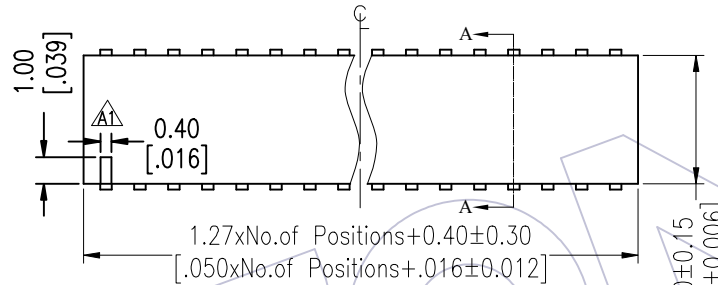
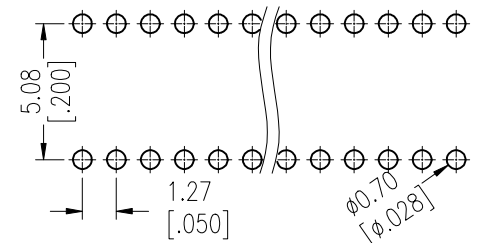

Ordering Information

2335-2 XX R XX C U N X 1

Plastic Row
No. of Pins Per Row: 02-50
Welding Type R=R/A
Contact Plating
G0=Gold Flash
G3=10u"Au, BG3=8u"PdNi+2u"Au
G4=15u"Au, BG4=13u"PdNi+2u"Au
G5=30u"Au, BG5=28u"PdNi+2u"Au
S0=Gold Flash/Tin
S3=10u"Au/Sn, P3=8u"PdNi+2u"Au/Sn
S4=15u"Au/Sn, P4=13u"PdNi+2u"Au/Sn
S5=30u"Au/Sn, P5=28u"PdNi+2u"Au/Sn
SN=Bright Tin

Series No.
Packing: T=Tube R=Tape&Reel
Logo N=W/O Logo
Contact Type U=U Type
Insulator Material C=PA9T

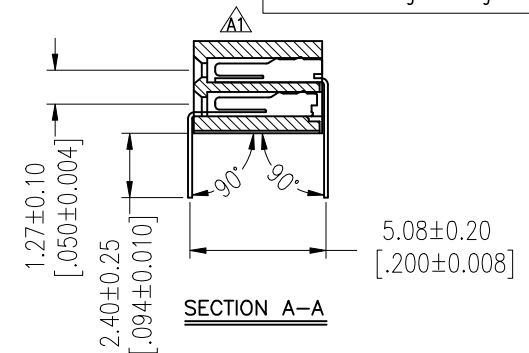
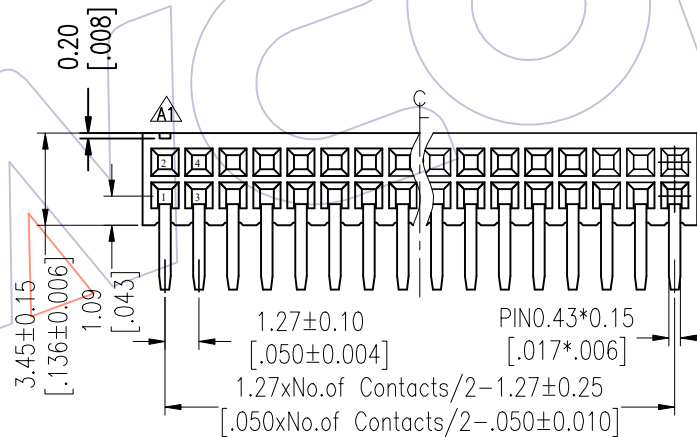

Item	Pitch	Mating	DIM.B
Standard	1.27	1310/1315/1320	3.00
Alternate			

REV	DATE	MODIFICATION DESCRIPTION	CHANGE	OPERATION	DRAW	DATE	SCALE	FIT	PART NO.
A2	2026/02/04	Standardization Drawing	BAO	x.x ±0.40	BAO	2026/02/04	UNIT	mm	2335-2XXRXXCUNX1
A1	2017/04/19	Modify plastic, Add Tape Packing	XSR	x.xx ±0.25	CHECK	DATE	SIZE	A4	TITLE: FH1.27 DUAL SIDE INSERT 90° H=3.45
AO	2012/07/07	NEW	-----	x.xxx ±0.15	TANG	2026/02/04	SHEET	1/3	
				Angle ± 3'	APPROVE	DATE	SHEET	1/3	Customer NO.
				DIM TOL	Steven Zhao	2026/02/04	PROJ.		

WCON
Http: www.wcon.com

WCON-Dongguan Tel: +86 769 85358920 Fax: +86 769 85358915 E-mail: sales@wcon.com

WCON-Kunshan Tel: +86 512 57468408 Fax: +86 512 57468468 E-mail: salesks@wcon.com

HSF

Packing:

Tube:

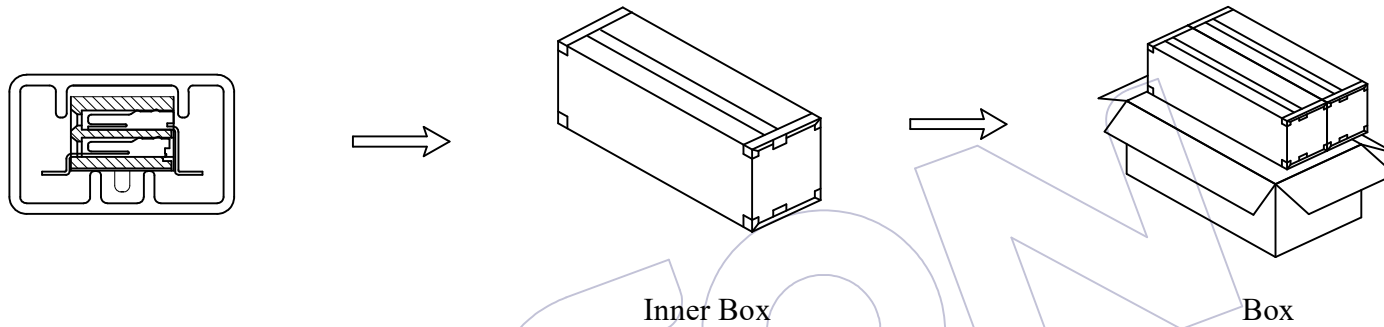

Reel:

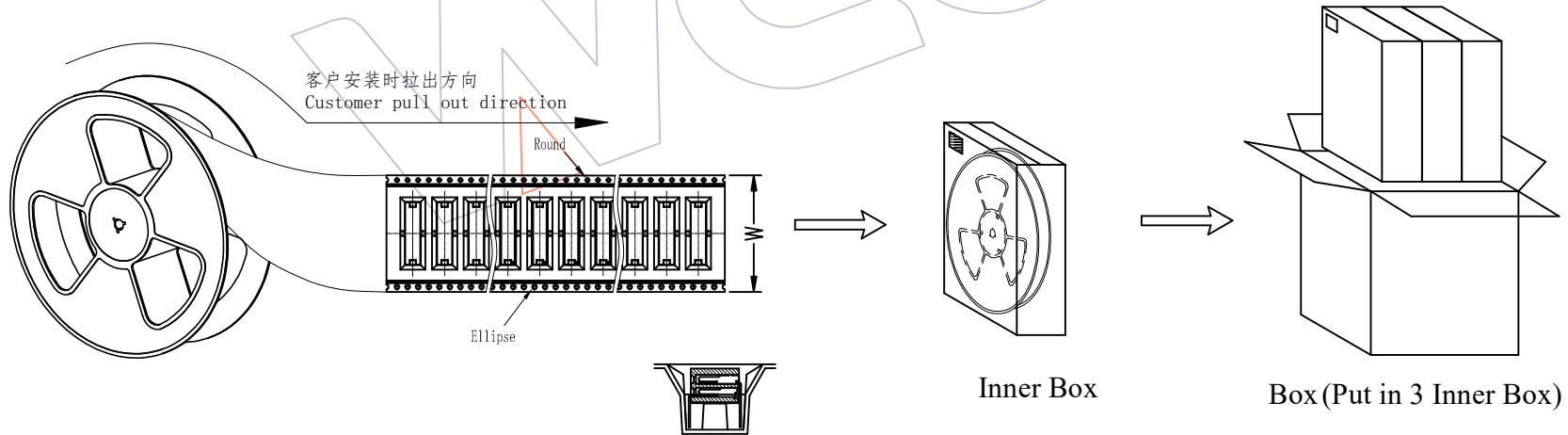

				OPERATION	DRAW	DATE	SCALE	FIT	PART NO.	
A2	2026/02/04	Standardization Drawing	BAO	x.X ±0.40	BAO	2026/02/04	UNIT	mm	2335-2XXRXXCUNX1	
A1	2017/04/19	Modify plasitc, Add Tape Packing	XSR	x.XX ±0.25	CHECK	DATE	SIZE	A4	TITLE:	
A0	2012/07/07	NEW	-----	x.XXX ±0.15	TANG	2026/02/04	SHEET	2/3	FH1.27 DUAL SIDE INSERT 90° H=3.45	
REV	DATE	MODIFICATION DESCRIPTION	CHANGE	Angle ± 3'	APPROVE	DATE	PROJ.		Customer NO.	
				DIM TOL	Steven Zhao	2026/02/04				

WCON

Http: www.wcon.com

WCON-Dongguan Tel: +86 769 85358920 Fax: +86 769 85358915 E-mail: sales@wcon.com	WCON-Kunshan Tel: +86 512 57468408 Fax: +86 512 57468468 E-mail: salesks@wcon.com
---	--

HSF

Packaging Quantity Refers To The Following Table

PINS /Row	Q' ty/Tube	Q' ty/Inner Box	Q' ty/Box	PINS /Row	Q' ty/Tube	Q' ty/Inner Box	Q' ty/Box	PINS /Row	W	Q' ty/Reel	Q' ty/Inner Box	Q' ty/Box	PINS /Row	W	Q' ty/Reel	Q' ty/Inner Box	Q' ty/Box
2	800/Tray	/	38,400	27	16	4,800	9,600	2	12	800	4,800	14,400	27	56	800	800	2,400
3	137	41,100	82,200	28	16	4,800	9,600	3	16	800	3,200	9,600	28	56	800	800	2,400
4	105	31,500	63,000	29	15	4,500	9,000	4	16	800	3,200	9,600	29	56	800	800	2,400
5	85	25,500	51,000	30	15	4,500	9,000	5	24	800	2,400	7,200	30	56	800	800	2,400
6	72	21,600	43,200	31	14	4,200	8,400	6	24	800	2,400	7,200	31	56	800	800	2,400
7	62	18,600	37,200	32	14	4,200	8,400	7	24	800	2,400	7,200	32	56	800	800	2,400
8	54	16,200	32,400	33	13	3,900	7,800	8	24	800	2,400	7,200	33	56	800	800	2,400
9	49	14,700	29,400	34	13	3,900	7,800	9	24	800	2,400	7,200	34	72	800	800	2,400
10	44	13,200	26,400	35	12	3,600	7,200	10	24	800	2,400	7,200	35	72	800	800	2,400
11	40	12,000	24,000	36	12	3,600	7,200	11	24	800	2,400	7,200	36	72	800	800	2,400
12	37	11,100	22,200	37	12	3,600	7,200	12	32	800	1,600	4,800	37	72	800	800	2,400
13	34	10,200	20,400	38	11	3,300	6,600	13	32	800	1,600	4,800	38	72	800	800	2,400
14	31	9,300	18,600	39	11	3,300	6,600	14	32	800	1,600	4,800	39	72	800	800	2,400
15	29	8,700	17,400	40	11	3,300	6,600	15	44	800	1,600	4,800	40	72	800	800	2,400
16	27	8,100	16,200	41	10	3,000	6,000	16	44	800	1,600	4,800	41	72	800	800	2,400
17	26	7,800	15,600	42	10	3,000	6,000	17	44	800	1,600	4,800	42	72	800	800	2,400
18	25	7,500	15,000	43	10	3,000	6,000	18	44	800	1,600	4,800	43	72	800	800	2,400
19	23	6,900	13,800	44	10	3,000	6,000	19	44	800	1,600	4,800	44	72	800	800	2,400
20	22	6,600	13,200	45	10	3,000	6,000	20	44	800	1,600	4,800	45	72	800	800	2,400
21	21	6,300	12,600	46	9	2,700	5,400	21	44	800	1,600	4,800	46	72	800	800	2,400
22	20	6,000	12,000	47	9	2,700	5,400	22	44	800	1,600	4,800	47	88	800	800	2,400
23	19	5,700	11,400	48	9	2,700	5,400	23	44	800	1,600	4,800	48	88	800	800	2,400
24	18	5,400	10,800	49	9	2,700	5,400	24	44	800	1,600	4,800	49	88	800	800	2,400
25	18	5,400	10,800	50	9	2,700	5,400	25	56	800	800	2,400	50	88	800	800	2,400
26	17	5,100	10,200					26	56	800	800	2,400					

A2	2026/02/04	Standardization Drawing	BAO	x.X	±0.40	DRAW BAO	DATE 2026/02/04	SCALE	FIT	PART NO. 2335-2XXRXXCUNX1	 Http: www.wcon.com WCON-Dongguan Tel: +86 769 85358920 WCON-Kunshan Tel: +86 512 57468408 Fax: +86 769 85358915 Fax: +86 512 57468468 E-mail: sales@wcon.com E-mail: sales@wcon.com
A1	2017/04/19	Modify plasitc, Add Tape Packing	XSR	x.XX	±0.25	CHECK TANG	DATE 2026/02/04	UNIT	mm	TITLE: FH1.27 DUAL SIDE INSERT 90° H=3.45	
A0	2012/07/07	NEW	-----	x.XXX	±0.15	APPROVE Steven Zhao	DATE 2026/02/04	SIZE	A4	Customer NO.	
REV	DATE	MODIFICATION DESCRIPTION	CHANGE	Angle	± 3'			SHEET	3/3		