

# HSF

**NOTES:**

Current Rating: 1.5AMP.(20°C, 1\*2P-1\*15P)

1.0AMP.(20°C, 1\*16P-1\*50P)  $\triangle A1$

Contact Resistance: 20mΩ Max

Withstand Voltage: 500V AC/DC

Insulation Resistance: 1000MΩ Min

Operation Temperature: -40°C to +125°C (Gold Plating)  $\triangle A1$   
 -40°C to +105°C (Tin Plating)  $\triangle A1$

Contact Material: Copper Alloy

Contact plating: Au Or Sn Over 30u" Min Ni  $\triangle A1$

Insulator Material: PA9T+G.F UL94V-0

Recommended P.C.B Layout (Top Side)  
 (PCB BOARD TOLERANCE  $\pm 0.05$ )  
 (PCB Thickness: T=1.60m)

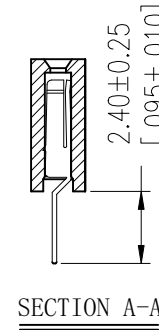
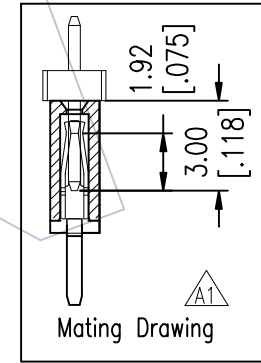
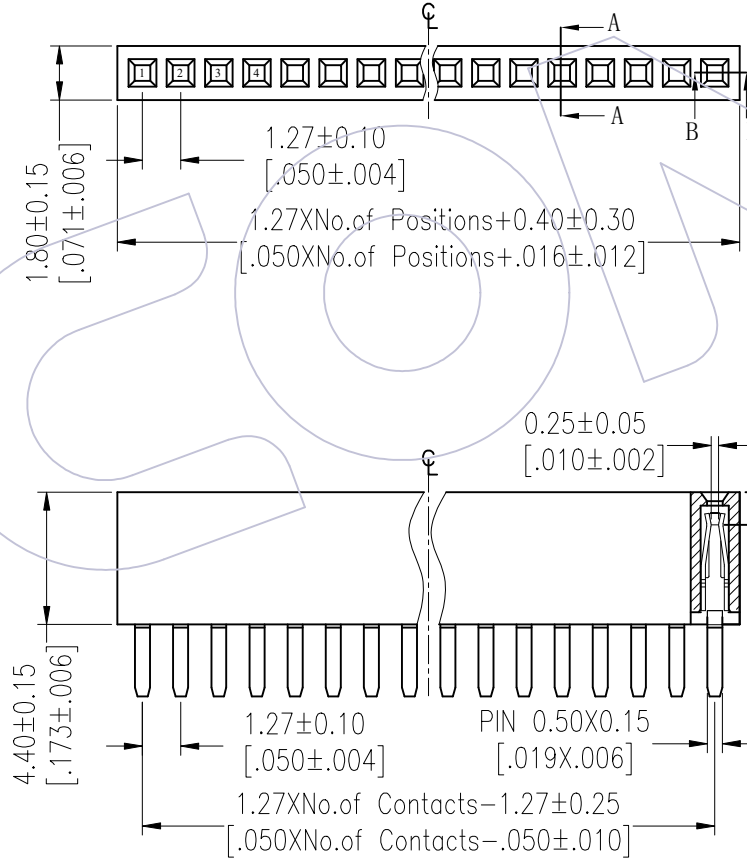
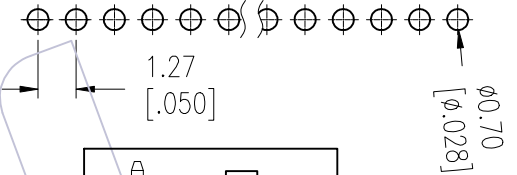

SECTION B-B

## Ordering Information

2344-1 XX S XX C UNT 1  $\triangle A1$

- Plastic Row
- No. of Pins Per Row: 02-50
- Welding Type S=S/T
- Contact Plating: G0=Gold Flash, G3=10u"Au, BG3=8u"PdNi+2u"Au, G4=15u"Au, BG4=13u"PdNi+2u"Au, G5=30u"Au, BG5=28u"PdNi+2u"Au, S0=Gold Flash/Tin, S3=10u"Au/Sn, P3=8u"PdNi+2u"Au/Sn, S4=15u"Au/Sn, P4=13u"PdNi+2u"Au/Sn, S5=30u"Au/Sn, P5=28u"PdNi+2u"Au/Sn, SN=Bright Tin
- Packing: T=Tube
- Logo N=W/O Logo
- Contact Type U=U Type
- Insulator Material C=PA9T
- Series No.

Item	Pitch	Mating	DIM.B
Standard	1.27	1310/1315/1320	3.00 $\triangle A1$
Alternate			

REV	DATE	MODIFICATION DESCRIPTION	CHANGE	OPERATION	DRAW CP	DATE	SCALE	FIT	PART NO.
A1	2026/01/30	Standardization Drawing	CP	x.x ±0.40	CP	2026/01/30	UNIT mm		2344-1XXSXXCUNT1
AO	2012/07/07	NEW	JYHuang	x.xx ±0.25	CHECK TANG	2026/01/30	SIZE A4		TITLE: FH 1.27mm SINGLE 180° DIP H=4.40
				x.xxx ±0.15	APPROVE Steven Zhao	2026/01/30	SHEET 1/2		Customer NO.
				Angle ± 3'			PROJ.		
				DIM TOL					

**WCON**  
 Http: www.wcon.com

WCON-Dongguan Tel: +86 769 85358920 Fax: +86 769 85358915 E-mail: sales@wcon.com

WCON-Kunshan Tel: +86 512 57468408 Fax: +86 512 57468468 E-mail: salesks@wcon.com

# HSF

## Packing:

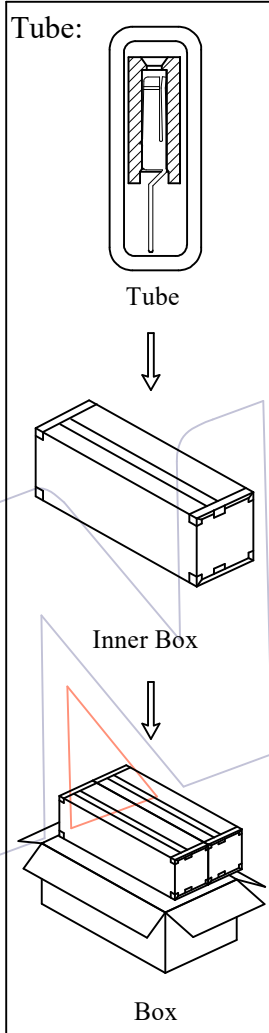

## Packaging Quantity Refers To The Following Table

PINS	Q' ty/Tube	Q' ty/Inner Box	Q' ty/Box
2	2,000/Tray		96,000
3	137	63,020	126,040
4	105	48,300	96,600
5	85	39,100	78,200
6	72	33,120	66,240
7	62	28,520	57,040
8	54	24,840	49,680
9	49	22,540	45,080
10	44	20,240	40,480
11	40	18,400	36,800
12	37	17,020	34,040
13	34	15,640	31,280
14	31	14,260	28,520
15	29	13,340	26,680
16	27	12,420	24,840
17	26	11,960	23,920
18	25	11,500	23,000
19	23	10,580	21,160
20	22	10,120	20,240
21	21	9,660	19,320
22	20	9,200	18,400
23	19	8,740	17,480
24	18	8,280	16,560
25	18	8,280	16,560
26	17	7,820	15,640

PINS	Q' ty/Tube	Q' ty/Inner Box	Q' ty/Box
27	16	7,360	14,720
28	16	7,360	14,720
29	15	6,900	13,800
30	15	6,900	13,800
31	14	6,440	12,880
32	14	6,440	12,880
33	13	5,980	11,960
34	13	5,980	11,960
35	12	5,520	11,040
36	12	5,520	11,040
37	12	5,520	11,040
38	11	5,060	10,120
39	11	5,060	10,120
40	11	5,060	10,120
41	10	4,600	9,200
42	10	4,600	9,200
43	10	4,600	9,200
44	10	4,600	9,200
45	10	4,600	9,200
46	9	4,140	8,280
47	9	4,140	8,280
48	9	4,140	8,280
49	9	4,140	8,280
50	9	4,140	8,280

				OPERATION		DRAW CP		DATE		SCALE		FIT		PART NO.	
				x.X	±0.40			2026/01/30		UNIT	mm			2344-1XXSXXCUNT1	
A1	2026/01/30	Standardization Drawing		x.XX	±0.25	CHECK TANG		DATE		SIZE	A4			TITLE: FH 1.27mm SINGLE 180° DIP H=4.40	
AO	2012/07/07	NEW		x.XXX	±0.15	APPROVE Steven Zhao		DATE		SHEET	2/2			Customer NO.	
REV	DATE	MODIFICATION DESCRIPTION		ANGLE	± 3'			DATE		PROJ.	⌀				
				DIM	TOL			2026/01/30							

**WCON**  
Http: www.wcon.com

WCON-Dongguan Tel: +86 769 85358920 Fax: +86 769 85358915 E-mail: sales@wcon.com  
 WCON-Kunshan Tel: +86 512 57468408 Fax: +86 512 57468468 E-mail: salesks@wcon.com