

# HSF

**NOTES:**

Current Rating: 1.5AMP.(20°C, 2\*2P-2\*15P)  
1.0AMP.(20°C, 2\*16P-2\*50P)

Contact Resistance: 20mΩ Max  
Withstand Voltage: 500V AC  
Insulation Resistance: 1000MΩ Min

Operation Temperature: -40°C to +125°C(Gold Plating)  
-40°C to +105°C(Tin Plating)

Contact Material: Copper Alloy  
Contact plating: Au or Sn Over 30u" Min Ni  
Insulator Material: PA9T+GF UL94V-0

## Ordering Information

2344-2 XX M XX C U N X 5

- Plastic Row
- No. of Pins Per Row: 02-50
- Welding Type M=SMT
- Contact Plating G0=Gold Flash G3=10u"Au, BG3=8u"PdNi+2u"Au G4=15u"Au, BG4=13u"PdNi+2u"Au G5=30u"Au, BG5=28u"PdNi+2u"Au S0=Gold Flash/Tin S3=10u"Au/Sn, P3=8u"PdNi+2u"Au/Sn S4=15u"Au/Sn, P4=13u"PdNi+2u"Au/Sn S5=30u"Au/Sn, P5=28u"PdNi+2u"Au/Sn SN=Bright Tin
- Packing: T=Tube P=Tube+CAP R=Tape&Reel+CAP
- Logo N=W/O Logo
- Contact Type U=U Type
- Insulator Material C=PA9T
- Series No. 5=W/T Bump

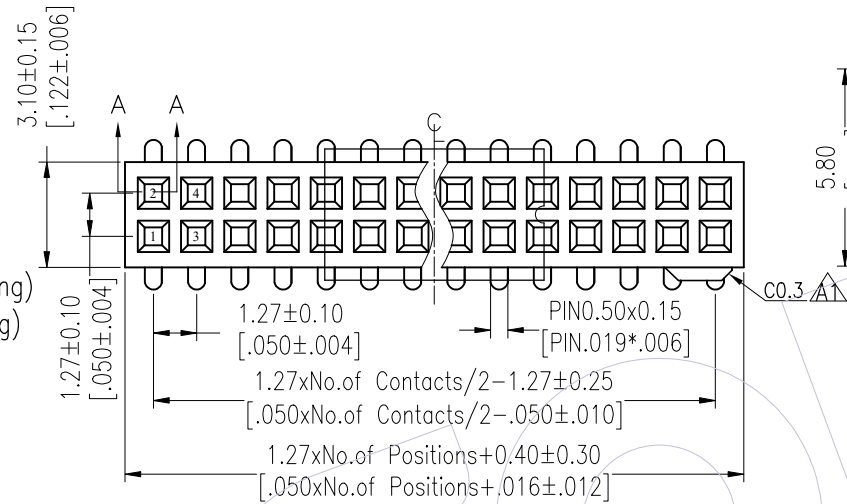

Recommended P.C.B Layout(Top Side)  
(PCB BOARD TOLERANCE±0.05)  
(PCB Thickness:T=1.60mm)

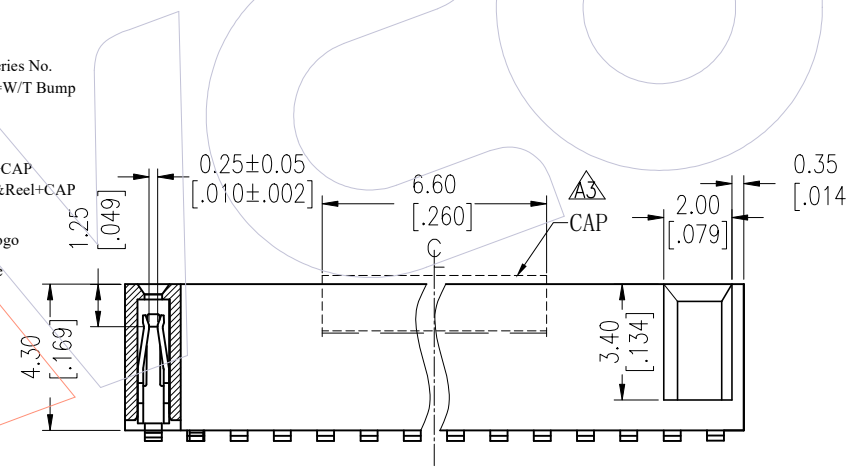
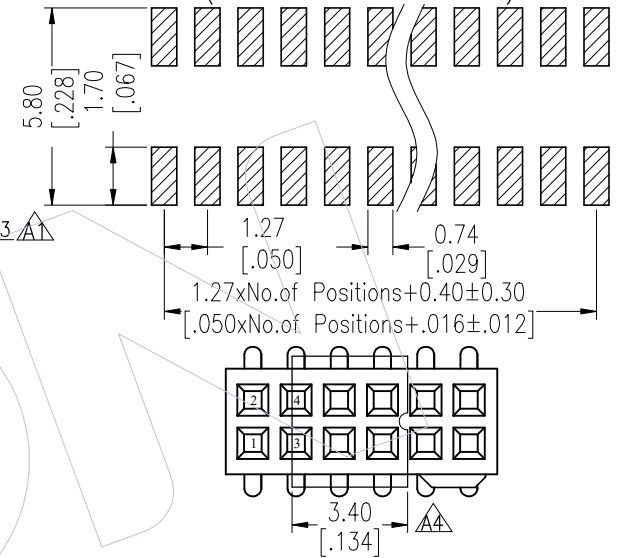

Special CAP for 2\*4P, 2\*5P, 2\*6P

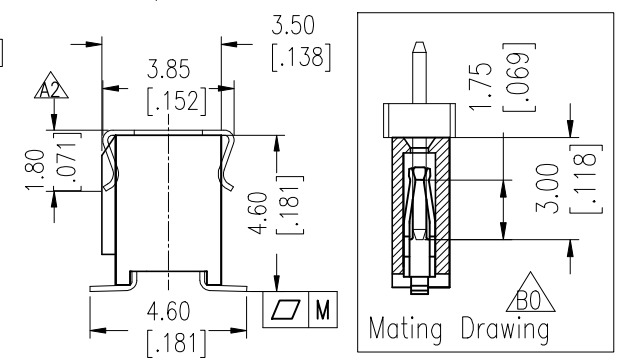

Item	Pitch	Mating	DIM.B
Standard	1.27	1310/1315/1320/3131/3133/3100	3.00
Alternate			

Pin(Per Row)	2-15P	16-30P	31-50P
	M	0.10	0.15

REV	DATE	MODIFICATION DESCRIPTION	CHANGE	OPERATION	DRAW	DATE	SCALE	FIT	PART NO.
B0	2026/02/03	Standardization Drawing	CP	OPERATION	DRAW	2026/02/03	SCALE	FIT	2344-2XXMXXCUNX5
A5	2023/02/03	Modify Flatness	XSR	x.X ±0.40	CP	2026/02/03	UNIT	mm	TITLE: 1.27mm Female Header DUAL SMT WITH BUMP H=4.30
A4	2016/06/17	Modify CAP 3.00 → 3.40	Wang	x.XX ±0.25	CHECK	2026/02/03	SIZE	A4	
A0	2012/07/09	NEW	JYHuang	x.XXX ±0.15	TANG	2026/02/03	SHEET	1/3	
REV	DATE	MODIFICATION DESCRIPTION	CHANGE	Angle ± 3'	APPROVE	DATE	SHEET	1/3	CUSTOMER NO.
				DIM TOL	Steven Zhao	2026/02/03	PROJ.		

**WCON**  
Http: www.wcon.com

WCON-Dongguan Tel: +86 769 85358920 Fax: +86 769 85358915 E-mail: sales@wcon.com

WCON-Kunshan Tel: +86 512 57468408 Fax: +86 512 57468468 E-mail: salesks@wcon.com

**HSF**

**Packing:**

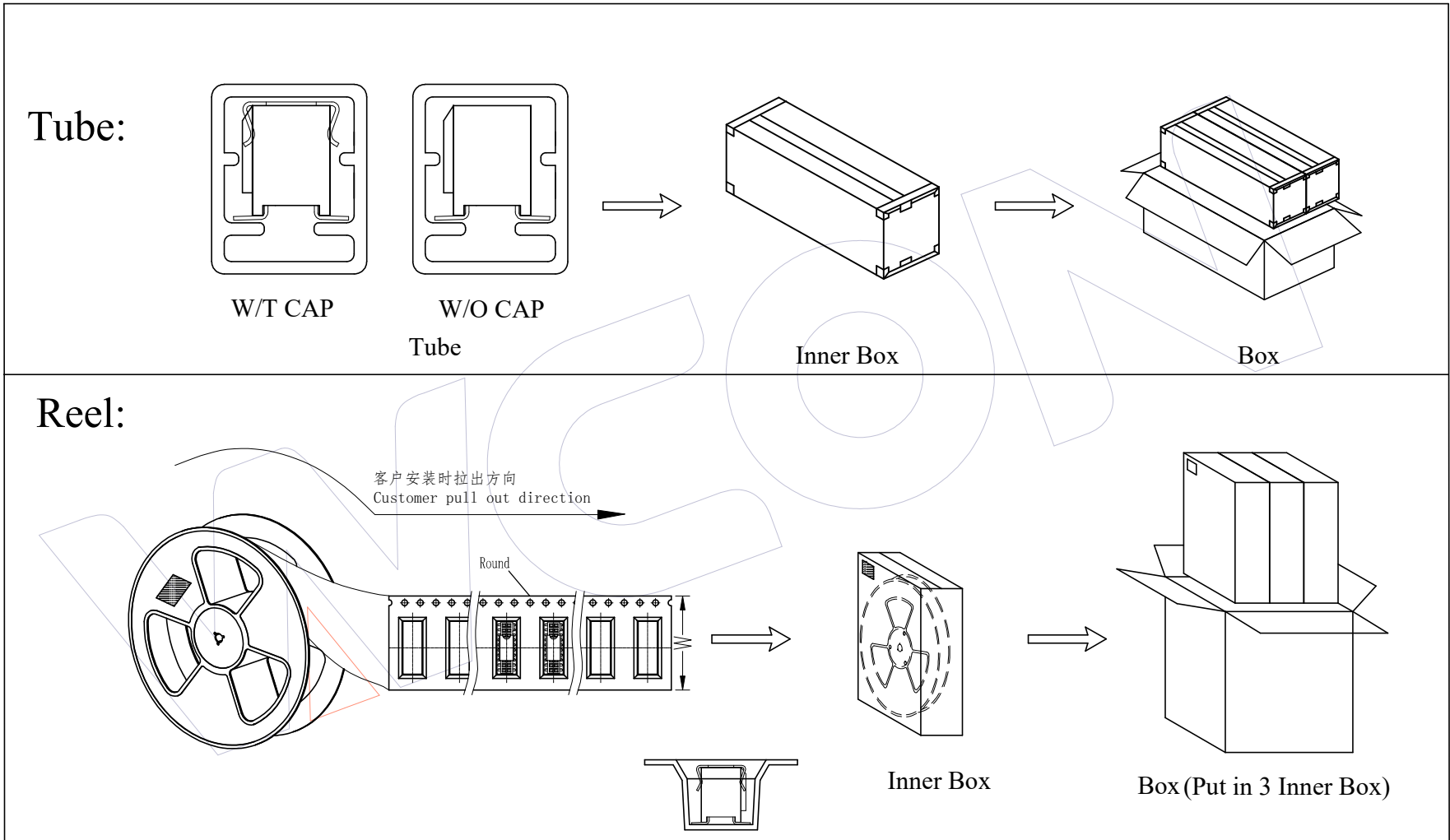

B0	2026/02/03	Standardization Drawing	CP	OPERATION		DRAW	DATE	SCALE	FIT	PART NO.
A5	2023/02/03	Modify Flatness	XSR	x.x	±0.40	CP	2026/02/03	UNIT	mm	2344-2XXMXXCUNX5
A4	2016/06/17	Modify CAP 3.00 → 3.40	Wang	x.xx	±0.25	CHECK	DATE	SIZE	A4	TITLE:
A0	2012/07/09	NEW	JYHuang	x.xxx	±0.15	TANG	2026/02/03	SHEET	2/3	1.27mm Female Header DUAL SMT WITH BUMP H=4.30
REV	DATE	MODIFICATION DESCRIPTION	CHANGE	Angle	± 3'	APPROVE	DATE	PROJ.	Customer NO.	
				DIM	TOL	Steven Zhao	2026/02/03			

**WCON**  
Http: www.wcon.com

WCON-Dongguan Tel: +86 769 85358920 Fax: +86 769 85358915 E-mail: sales@wcon.com	WCON-Kunshan Tel: +86 512 57468408 Fax: +86 512 57468468 E-mail: salesks@wcon.com
---	--

HSF

# Packaging Quantity Refers To The Following Table

PINS /Row	Q' ty/Tube	Q' ty/Inner Box	Q' ty/Box
2	800/Tray		38,400
3	137	43,840	87,680
4	105	33,600	67,200
5	86	27,520	55,040
6	72	23,040	46,080
7	62	19,840	39,680
8	54	17,280	34,560
9	49	15,680	31,360
10	44	14,080	28,160
11	40	12,800	25,600
12	37	11,840	23,680
13	34	10,880	21,760
14	31	9,920	19,840
15	29	9,280	18,560
16	27	8,640	17,280
17	26	8,320	16,640
18	24	7,680	15,360
19	23	7,360	14,720
20	22	7,040	14,080
21	21	6,720	13,440
22	20	6,400	12,800
23	19	6,080	12,160
24	18	5,760	11,520
25	18	5,760	11,520
26	17	5,440	10,880

PINS /Row	Q' ty/Tube	Q' ty/Inner Box	Q' ty/Box
27	16	5,120	10,240
28	16	5,120	10,240
29	15	4,800	9,600
30	14	4,480	8,960
31	14	4,480	8,960
32	14	4,480	8,960
33	13	4,160	8,320
34	13	4,160	8,320
35	12	3,840	7,680
36	12	3,840	7,680
37	12	3,840	7,680
38	11	3,520	7,040
39	11	3,520	7,040
40	11	3,520	7,040
41	11	3,520	7,040
42	10	3,200	6,400
43	10	3,200	6,400
44	10	3,200	6,400
45	10	3,200	6,400
46	9	2,880	5,760
47	9	2,880	5,760
48	9	2,880	5,760
49	9	2,880	5,760
50	9	2,880	5,760

PINS /Row	W	Q' ty/Reel	Q' ty/Inner Box	Q' ty/Box
2	16	900	3,600	10,800
3	16	900	3,600	10,800
4	16	900	3,600	10,800
5	16	900	3,600	10,800
6	24	900	2,700	8,100
7	24	900	2,700	8,100
8	24	900	2,700	8,100
9	24	900	2,700	8,100
10	24	900	2,700	8,100
11	24	900	2,700	8,100
12	32	900	1,800	5,400
13	32	900	1,800	5,400
14	32	900	1,800	5,400
15	32	900	1,800	5,400
16	32	900	1,800	5,400
17	44	900	1,800	5,400
18	44	900	1,800	5,400
19	44	900	1,800	5,400
20	44	900	1,800	5,400
21	44	900	1,800	5,400
22	44	900	1,800	5,400
23	44	900	1,800	5,400
24	44	900	1,800	5,400
25	44	900	1,800	5,400
26	56	900	900	2,700

PINS /Row	W	Q' ty/Reel	Q' ty/Inner Box	Q' ty/Box
27	56	900	900	2,700
28	56	900	900	2,700
29	56	900	900	2,700
30	56	900	900	2,700
31	56	900	900	2,700
32	56	900	900	2,700
33	56	900	900	2,700
34	56	900	900	2,700
35	56	900	900	2,700
36	72	900	900	2,700
37	72	900	900	2,700
38	72	900	900	2,700
39	72	900	900	2,700
40	72	900	900	2,700
41	72	900	900	2,700
42	72	900	900	2,700
43	72	900	900	2,700
44	72	900	900	2,700
45	72	900	900	2,700
46	72	900	900	2,700
47	72	900	900	2,700
48	88	900	900	2,700
49	88	900	900	2,700
50	88	900	900	2,700

B0	2026/02/03	Standard Pin Pressing	CP	OPERATION	DRAW	DATE	SCALE	FIT	PART NO.
A5	2023/02/03	Modify Flatness	XSR	x.X ±0.40	CP	2026/02/03	UNIT	mm	2344-2XXMXXCUNX5
A4	2016/06/17	Modify CAP 3.00 → 3.40	Wang	x.xx ±0.25	CHECK	DATE	SIZE	A4	TITLE:
A0	2012/07/09	NEW	JYHuang	x.xxx ±0.15	TANG	2026/02/03	SHEET	3/3	1.27mm Female Header DUAL SMT WITH BUMP H=4.30
REV	DATE	MODIFICATION DESCRIPTION	CHANGE	Angle ± 3°	APPROVE	DATE	PROJ.	Customer NO.	
				DIM TOL	Steven Zhao	2026/02/03			

**WCON**

Http: www.wcon.com

WCON-Dongguan Tel: +86 769 85358920 Fax: +86 769 85358915 E-mail: sales@wcon.com	WCON-Kunshan Tel: +86 512 57468408 Fax: +86 512 57468468 E-mail: salesks@wcon.com
---	--