

2.00mm (0.079")pitch,compact size connector for automotive application
2.00毫米（0.079英寸）间距，适用于汽车应用的紧凑型汽车连接器

Overview

72025 series features a compact design and suitable for wire-to-board connection. It is specially design for high-temperature environments which can be up to 125°C. It is a dual-row STM configuration for automated mounting

概述

72025系列连接器采用紧凑型设计，适用于线到板连接方式，专为高温环境设计，可承受高达125°C的温度，并采用双排SMT(表面贴装技术)实现自动化安装。

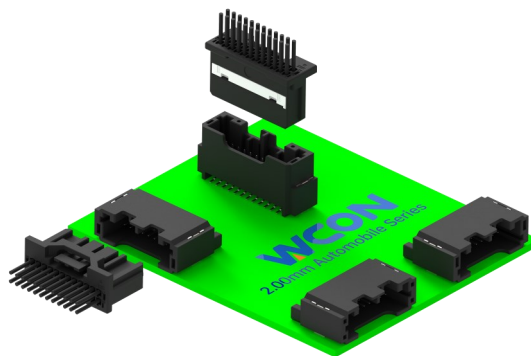

Features and Benefits

- TPA design enhances terminal retention force and prevents pulling out.
- Press-to-unlock, easy and convenient operation
- Multiple anti-misinsertion structure designs
- Multiple connection options for flexible application
- A safety lock system with auditory, tactile and visual mating recognition

特点与优势

- TPA设计，增强端子保持力，防止脱拉
- 按压式解锁，操作简单便捷
- 多种防误插结构设计
- 多种连接方式，灵活应用
- 具有听觉、触觉和视觉交互识别系统

Product Applications

- In-vehicle device interface
- Automotive power system
- Entertainment and audio-visual system

应用领域

- 车载设备接口
- 汽车动力系统
- 娱乐影音系统

Standard 标准

- QC/T 1067
- GB/T 5095
- IEC 60512

Material 材料

Part/零件	Material/材料	Finish/电镀	UL Flame retardant/阻燃等级
Header/板端	PPS	Black/黑色 Blue/蓝色 Natural/自然色	UL94V-0
Housing/主体	PBT	Black/黑色	UL94V-0
TPA/二次锁扣	PBT	Natural/自然色	UL94V-0
Terminal/端子	Copper Alloy	Plated Sn 镀锡	-

Production Specifications 产品规格

Current rating 额定电流	3.0 A	Operating Temperature Range:-40° C~+125° (including temperature rise) Operating Humidity Range:20-80% 工作温度范围: -40° C~+125° C(含温升) 工作湿度范围: 20-80%	Storage Teroerature:25±5° C Humidity:≤60% 储存温度: 25±5° C 储存湿度: ≤60%
Voltage rating 额定电压	50V		

Item 项目	Condition 条件	Specification 规格
Insulation Resistance 绝缘电阻	Measured at 500V DC for 1 minute 测试电压: 500V DC/1分钟	No less than 100M Ω 不少于100MΩ
Withstanding voltage 耐电压	Measured at 1000V AC for 1 minute 测试电压: 1000V AC/1分钟	No breakdown, no discharge, leakage current <3mA 无击穿、无放电、漏电流<3 mA
Contact Resistance 接触电阻	Test Voltage 测试电压: 20mV Max Test current 测试电流: 50mA Max	Contact resistance: Initial value/ 12 mo max After environmental tests/ 15 mo max. 接触电阻: 初始值 12 mΩ 以下 测试后 15 mΩ 以下
Vibration Resistance 抗振动	Frequency: 15 ~ 500 Hz Peak acceleration: 20 G's Duration: 24H /axis Vibration: X/Y/Z 频率: 15 ~ 500 Hz 峰值加速度: 20 G 时长: 24H/轴 方向: X/Y/Z	No electrical discontinuity of 1μs or greater 试验过程中未发生1μs瞬断现象, 且外观无损伤, 电气性能正常
Temperature life 高温老化	Temperature 温度: 135°C Duration 时间: 100H	Contact resistance: Initial value/ 12 mo max After environmental tests/ 15 mo max. 接触电阻: 初始值 12 mΩ 以下 测试后 15 mΩ 以下
Salt Spray 盐雾	Temperature 温度: 35±2°C Salt solution concentration 盐浓度: 5±1% pH Value 酸碱值: 6.5~7.2 Duration 时间: 24H	Contact resistance: Initial value/ 12 mo max After environmental tests/ 15 mo max. 接触电阻: 初始值 12 mΩ 以下 测试后 15 mΩ 以下
Durability(Mating/un- mating) 插拔寿命	50 cycles 循环50次	Contact resistance: Initial value/ 12 mo max After environmental tests/ 15 mo max. 接触电阻: 初始值 12 mΩ 以下 测试后 15 mΩ 以下

PCB Layout 印刷电路板布局

Surface Mount Technology 表面贴装
(72025-2MZ0XXFBSNBRX (W))

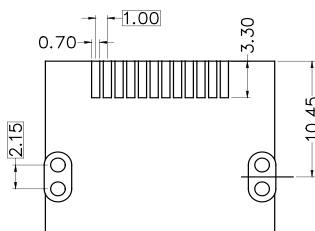

Surface Mount Technology 表面贴装
(72025-2MM0XXFXXXBRX (W))

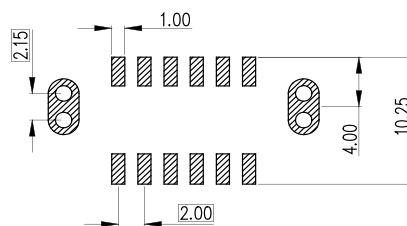

72025 Series

Dimensions 尺寸

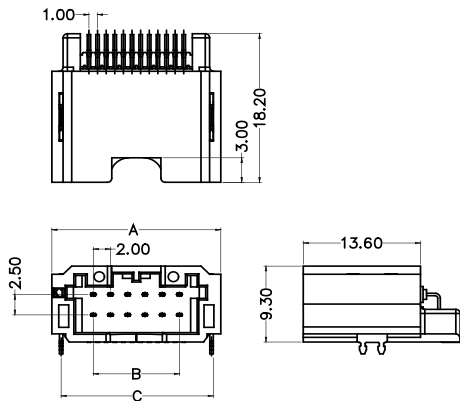

Order Information 订购信息

Circuit 芯数	Part number 型号	Dimensions 尺寸 (mm)			Package 包装 Q'ty/Reel 只/卷装	Remake 可量产状态
		A	B	C		
8	72025-2MZ008FBSNBRX (W)	15.60	6.00	13.45	190	*
12	72025-2MZ012FBSNBRX (W)	19.60	10.00	17.45	190	*
16	72025-2MZ016FBSNBRX (W)	23.60	14.00	21.45	190	*
20	72025-2MZ020FBSNBRX (W)	27.60	18.00	25.45	190	*
24	72025-2MZ024FBSNBRX (W)	31.60	22.00	29.45	190	*
28	72025-2MZ028FBSNBRX (W)	35.60	26.00	33.45	190	*
32	72025-2MZ032FBSNBRX (W)	39.60	30.00	37.45	190	*
40	72025-2MZ040FBSNBRX (W)	47.60	38.00	45.45	190	*

Note: * stands for mass production . 注: *代表可量产

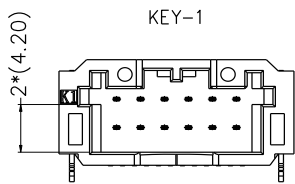

72025-2MZ0XXFBSNBR1 (W)

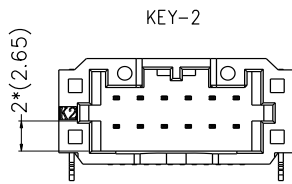

72025-2MZ0XXFBSNBR2 (W)

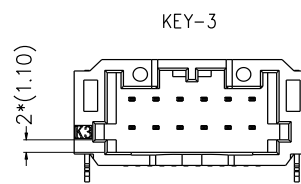

72025-2MZ0XXFBSNBR3 (W)

Dimensions 尺寸

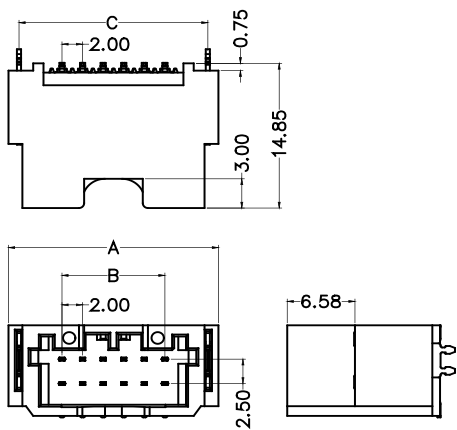

Order Information 订购信息

Circuit 芯数	Part number 型号	Dimensions 尺寸 (mm)			Package 包装 Q'ty/Reel 只/卷装	Remake 可量产状态
		A	B	C		
8	72025-2MM008FXSNBRX (W)	16.40	6.00	14.35	140	*
12	72025-2MM012FXSNBRX (W)	20.40	10.0	18.35	140	*
16	72025-2MM016FXSNBRX (W)	24.40	14.00	22.35	140	*
20	72025-2MM020FXSNBRX (W)	28.40	18.00	26.35	140	*
24	72025-2MM024FXSNBRX (W)	32.40	22.00	30.35	140	*
28	72025-2MM028FXSNBRX (W)	36.40	26.00	34.35	140	*
32	72025-2MM032FXSNBRX (W)	40.40	30.00	38.35	140	*
40	72025-2MM040FXSNBRX (W)	48.40	38.00	46.35	140	*

Note: * stands for mass production . 注: *代表可量产

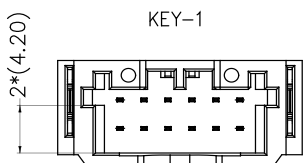

72025-2MM0XXFXXXBR1 (W)

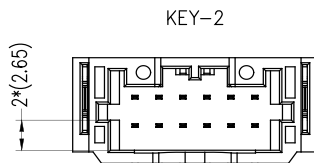

72025-2MM0XXFXXXBR2 (W)

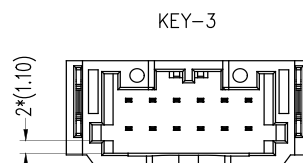

72025-2MM0XXFXXXBR3 (W)

Dimensions 尺寸

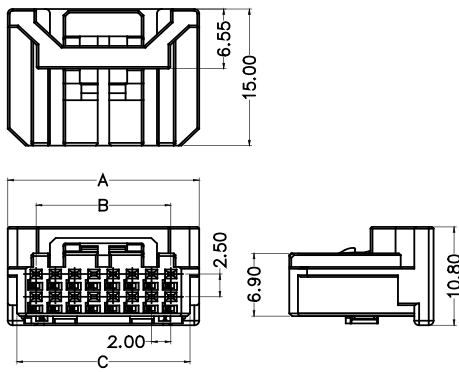

Order Information 订购信息

Circuit 芯数	Part number 型号	Dimensions 尺寸 (mm)			Parkage 包装 Q'ty/Tray 只/盒装	Remake 可量产状态
		A	B	C		
8	72025-2FC008AX00BAX (W)	11.90	6.00	10.00	216	*
12	72025-2FC012AX00BAX (W)	15.90	10.00	14.00	162	*
16	72025-2FC016AX00BAX (W)	19.90	14.00	18.00	126	*
20	72025-2FC020AX00BAX (W)	23.90	18.02	22.00	108	*
24	72025-2FC024AX00BAX (W)	27.90	22.00	26.00	90	*
28	72025-2FC028AX00BAX (W)	31.90	26.00	30.00	81	*
32	72025-2FC032AX00BAX (W)	35.90	30.00	34.00	72	*
40	72025-2FC040AX00BAX (W)	43.90	38.00	42.00	54	*

Note: * stands for mass production . 注: *代表可量产

Adaptor Terminal 适配端子

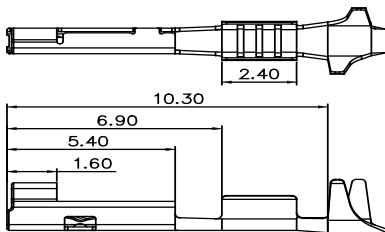

Order Information 订购信息

型号 Model number	电线规格 Wire size	绝缘外径 Insulation O.D	适配外壳 Adaptor Housing
72025-TC22SN01	AWG#22	1.10-1.50mm	72025-2FCXXXXX00BAX(W)

Terminal Crimping Specification 端子压接规范

型号 Model number	电线类型 Wire type	电线规格 Wire size	线缆 OD (mm) Cable OD (mm)	剥线长度 (mm) Strip length (mm)	导体铆压 (A-A) Conductor crimp			绝缘体铆压 (B-B) Insulation crimp	
					压接宽度CB1 Crimping width CB1±0.03mm	压接宽度CBm1 Crimping height CBm1±0.05mm	压接高度 Crimping height CH1±0.03m	压接宽度CBm2 Crimping width CBm2±0.05mm	压接高度CH2 Crimping width CH2±0.08mm
72025- TC22SN01	AVSS	0.35mm ²	1.40±0.1	3.40±0.1	1.14	1.14	0.85	1.55	1.46
	FLRY-A	0.35mm ²	1.20±0.1		1.16	1.16	0.84	1.55	1.35
	UL1332	22AWG	1.40±0.1		1.13	1.13	0.78	1.55	1.46

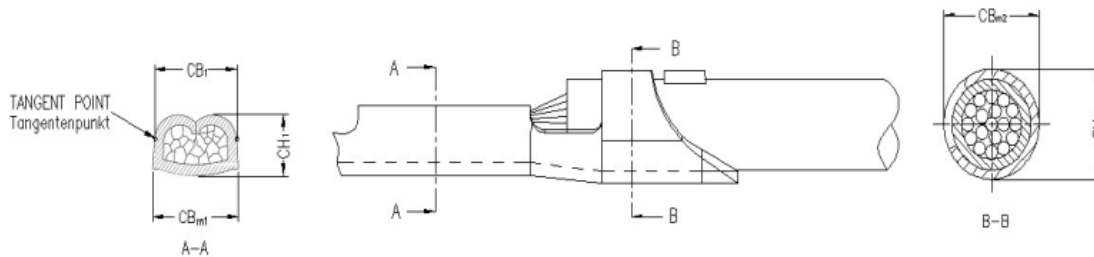

72025 Series

Model Numbering 型号命名

72025	-	2	M	X	XXX	F	X	SN	B	R	X	(W)
(1)		(2)	(3)	(4)	(5)	(6)	(7)	(8)	(9)	(10)	(11)	(12)
(1) Series (系列): 2.00*2.50mm Automotive Series						(7) Color(颜色): B=Black、T=Natural、B=Blue						
(2) Rows (排数): 2=Dual Rows						(8) Contact Plating(电镀): Sn over Ni						
(3) Product type (产品类型): M=Male						(9) Non-watertight						
(4) Terminal type(端子形态): Z=R/A SMT M=V/T SMT						(10) Packing(包装): R=Reel						
(5) Positions(位数): 008=8.....040=40P						(11) Running Number(流水码) 1=KEY 1、2=KEY 2、3=KEY 3						
(6) Plastic Material(塑胶材料): F=PPS						(12) Logo(标志): W=With WCON Black=Without WCON						

72025	-	2	F	C	XXX	A	X	00	B	X	1	(W)
(1)		(2)	(3)	(4)	(5)	(6)	(7)	(8)	(9)	(10)	(11)	(12)
(1) Series (系列): 2.20*3.00mm Automotive Series						(7) Color(颜色): B=Black、T=Natural、B=Blue						
(2) Rows (排数): 2=Dual Rows						(8) Terminal(端子): Without Terminal						
(3) Product type (产品类型): F=Female						(9) Non-watertight						
(4) Terminal type(端子形态): C=Crimp Type						(10) Packing(包装): A=Tray、0=PE Bag						
(5) Positions(位数): 008=8.....040=40P						(11) Running Number(流水码) 1=KEY 1、2=KEY 2、3=KEY 3						
(6) Plastic Material(塑胶材料): A=PBT						(12) Logo(标志): W=With WCON Black=Without WCON						

Contact Us 联系我们

维峰电子股份有限公司(总部)
WCON ELECTRONICS CO.,LTD(HQ)
地址:广东省东莞市虎门镇大宁文明路15号
Add :No.15,Wenming Road,Daning Community, Humen Town,
Dongguan, Guangdong.523930, China

昆山维康电子有限公司
KUNSHAN WCON ELECTRONICS CO.,LTD(East of China)
地址:昆山市千灯镇汶浦中路169号
Add : No.169, WenPu Middle Road, QianDeng Town, Kunshan
City, Jiangsu Province, China

合肥维峰电子有限公司
HEFEI WCON ELECTRONICS CO.,LTD
地址:安徽合肥市高新技术开发区绿城科技园E栋2楼
Add : 2F, Building E, Greentown Science Park,High-tech Development Zone, Hefei, Anhui,China

维康电子(泰国)有限公司
WCON ELECTRONICS (Thailand) CO.,LTD
地址:泰国巴真武里府西玛铺县华瓦区洛加纳工业园
Add: VG3C+H57, Hua Wa, Si Maha Phot District, Prachin Buri
25140, Thailand

销售联系方式 Contacts Information

国际客户部 International sales department
salesdg01@wcon.com
salesdg05@wcon.com

大客户专线 Major customer dedicated department

华南: salesdg28@wcon.com
华东: salesks@wcon.com

中小客户专线 Public Customer hot line

华南: salesdg10@wcon.com
华东: salesks01@wcon.com

网络销售 Online sales department

salesdg26@wcon.com



Official Website



Product e-catalog



WeChat Public#



TikTok Public#